



ART. 030 Tri-Clamp Tee

ASTM A270 Flange design according to ASME-BPE

Size	Ø A	Ø De	Ø Di	L	Material	Finishing	Code
1/2"	25,00	12,70	9,40	39,00	1.4404	ML	030C60050ML
1/2"	25,00	12,70	9,40	66,60	1.4404	ML	030Z60050ML
3/4"	25,00	19,05	15,75	48,00	1.4404	ML	030C60075ML
3/4"	25,00	19,05	15,75	66,60	1.4404	ML	030Z60075ML
1"	50,50	25,40	22,10	60,30	1.4404	ML	030Z60100ML
1.1/2"	50,50	38,10	34,80	69,90	1.4404	ML	030Z60150ML
2"	64,00	50,80	47,50	88,90	1.4404	ML	030Z60200ML
2.1/2"	77,40	63,50	60,20	88,90	1.4404	ML	030Z60250ML
3"	90,90	72,60	72,90	95,30	1.4404	ML	030Z60300ML
4"	118,90	101,60	97,39	114,30	1.4404	ML	030Z60400ML

ML

Int. finishing: $Ra \leq 0,4 \mu\text{m}$ Machined Finish
Ext. finishing: $Ra \leq 0,8 \mu\text{m}$ Mirror Polished

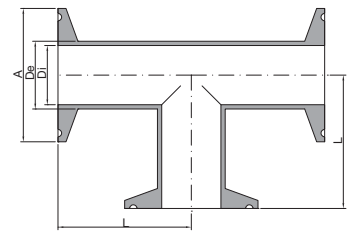

ART. 031 Tri-Clamp Elbow

ASTM A270 Flange design according to ASME-BPE

Size	Ø A	Ø De	Ø Di	L	Material	Finishing	Code
1/2"	25,00	12,70	9,40	39,00	1.4404	ML	031C60050ML
1/2"	25,00	12,70	9,40	88,80	1.4404	ML	031Z60050ML
3/4"	25,00	19,05	15,75	48,00	1.4404	ML	031C60075ML
3/4"	25,00	19,05	15,75	88,80	1.4404	ML	031Z60075ML
1"	50,50	25,40	22,10	50,80	1.4404	ML	031Z60100ML
1.1/2"	50,50	38,10	34,80	69,90	1.4404	ML	031Z60150ML
2"	64,00	50,80	47,50	88,90	1.4404	ML	031Z60200ML
2.1/2"	77,40	63,50	60,20	108,00	1.4404	ML	031Z60250ML
3"	90,90	72,60	72,90	127,00	1.4404	ML	031Z60300ML
4"	118,90	101,60	97,39	168,30	1.4404	ML	031Z60400ML

ML

Int. finishing: $Ra \leq 0,4 \mu\text{m}$ Machined Finish
Ext. finishing: $Ra \leq 0,8 \mu\text{m}$ Mirror Polished

