

// Accurate flow
management to keep
process under control

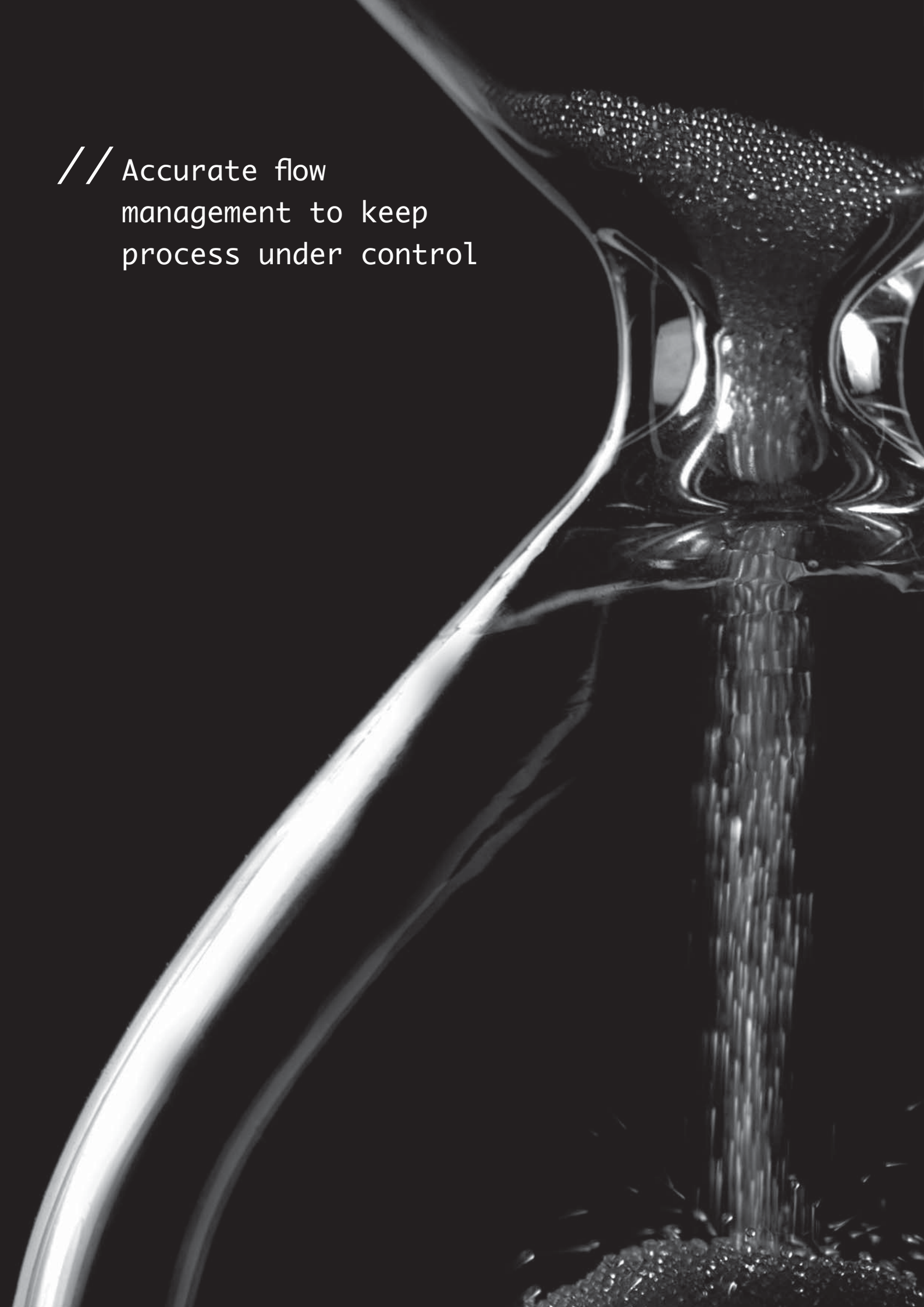

NEEDLE VALVES



ART. 049/Z
Needle Valves
Tri-Clamp

P. 060



ART. 049/W
Needle Valves
Butt Weld

P. 062



ART. 053
Needle Valves
Gas Threaded

P. 066



ART. 054
Gauge Holder
Gas Threaded

P. 067

Characteristics. Valve body machined from solid compound. Double metal closure, no gaskets between the body and the rod valve guide.

Documentation. Laser marking for traceability and validation processes. Material 3.1 certificates, FDA or USP, internal surface finishing check.



ASTM A270 Tri-Clamp

Size	Ø A	Ø B	Ø D	Ø L	Valve Material	Gasket Material	Code
1/4"	25,00	4,57	4,00	101,60	1.4404	PTFE - FDA	049Z60025PT70
						PTFE - USP 121	049Z60025PT121
3/8"	25,00	7,75	5,50	101,60	1.4404	PTFE - FDA	049Z60037PT70
						PTFE - USP 121	049Z60037PT121
1/2"	25,00	9,40	5,50	101,60	1.4404	PTFE - FDA	049Z60050PT70
						PTFE - USP 121	049Z60050PT121
3/4"	25,00	15,75	7,00	101,60	1.4404	PTFE - FDA	049Z60075PT70
						PTFE - USP 121	049Z60075PT121
1"	50,50	22,10	9,00	114,30	1.4404	PTFE - FDA	049Z60100PT70
						PTFE - USP 121	049Z60100PT121
1.1/2"	50,50	34,80	11,50	139,70	1.4404	PTFE - FDA	049Z60150PT70
						PTFE - USP 121	049Z60150PT121
2"	64,00	47,50	17,00	158,80	1.4404	PTFE - FDA	049Z60200PT70
						PTFE - USP 121	049Z60200PT121
2.1/2"	77,50	60,20	27,50	212,00	1.4404	PTFE - FDA	049Z60250PT70
						PTFE - USP 121	049Z60250PT121

Int. finishing: **Ra ≤ 0,4 µm**
Ext. finishing: **Ra ≤ 0,8 µm Mirror Polished**

Max Working Conditions:
10 bar (120 psi) and 150°C (300°F)

Gaskets:
FDA approved PTFE
or USP CLASS VI - 121° PTFE

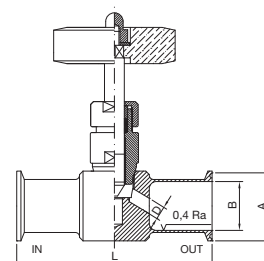

DIN 32676 Tri-Clamp

Size	Ø A	Ø B	Ø D	Ø L	Valve Material	Gasket Material	Code
DN10	34,00	10,00	5,50	101,60	1.4404	PTFE - FDA	049Z6D010PT70
						PTFE - USP 121	049Z6D010PT121
DN15	34,00	16,00	7,00	87,00	1.4404	PTFE - FDA	049Z6D015PT70
						PTFE - USP 121	049Z6D015PT121
DN20	34,00	20,00	7,00	87,00	1.4404	PTFE - FDA	049Z6D020PT70
						PTFE - USP 121	049Z6D020PT121
DN25	50,50	26,00	9,00	114,30	1.4404	PTFE - FDA	049Z6D025PT70
						PTFE - USP 121	049Z6D025PT121
DN32	50,50	32,00	11,50	139,70	1.4404	PTFE - FDA	049Z6D032PT70
						PTFE - USP 121	049Z6D032PT121
DN40	50,50	38,00	11,50	139,70	1.4404	PTFE - FDA	049Z6D040PT70
						PTFE - USP 121	049Z6D040PT121

Int. finishing: **Ra ≤ 0,4 µm**
Ext. finishing: **Ra ≤ 0,8 µm Mirror Polished**

Max Working Conditions:
10 bar (120 psi) and 150°C (300°F)

Gaskets:
FDA approved PTFE
or USP CLASS VI - 121° PTFE

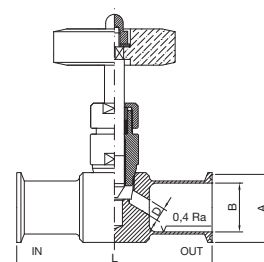



ISO 1127 Tri-Clamp

Size	Ø A	Ø B	Ø D	Ø L	Valve Material	Gasket Material	Code
DN8	34,00	10,30	5,50	101,60	1.4404	PTFE - FDA	049Z61008PT70
						PTFE - USP 121	049Z61008PT121
DN10	34,00	14,00	5,50	101,60	1.4404	PTFE - FDA	049Z61010PT70
						PTFE - USP 121	049Z61010PT121
DN15	34,00	18,10	7,00	87,00	1.4404	PTFE - FDA	049Z61015PT70
						PTFE - USP 121	049Z61015PT121
DN20	50,50	23,70	9,00	114,30	1.4404	PTFE - FDA	049Z61020PT70
						PTFE - USP 121	049Z61020PT121
DN25	50,50	29,70	9,00	114,30	1.4404	PTFE - FDA	049Z61025PT70
						PTFE - USP 121	049Z61025PT121
DN32	50,50	38,40	11,50	139,70	1.4404	PTFE - FDA	049Z61032PT70
						PTFE - USP 121	049Z61032PT121
DN40	50,50	44,30	11,50	139,70	1.4404	PTFE - FDA	049Z61040PT70
						PTFE - USP 121	049Z61040PT121

Int. finishing: $Ra \leq 0,4 \mu m$
 Ext. finishing: $Ra \leq 0,8 \mu m$ Mirror Polished

Max Working Conditions:
10 bar (120 psi) and 150°C (300°F)

Gaskets:
FDA approved PTFE
or USP CLASS VI - 121° PTFE

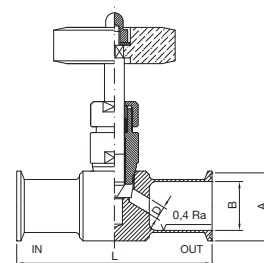



ASTM A270 Butt Weld

Size	Ø A	Ø B	Ø D	Ø L	Valve Material	Gasket Material	Code
1/4"	6,35	4,57	4,00	101,60	1.4404	PTFE - FDA	049W60025PT70
						PTFE - USP 121	049W60025PT121
3/8"	9,53	7,75	5,50	101,60	1.4404	PTFE - FDA	049W60037PT70
						PTFE - USP 121	049W60037PT121
1/2"	12,7	9,40	5,50	101,60	1.4404	PTFE - FDA	049W60050PT70
						PTFE - USP 121	049W60050PT121
3/4"	19,05	15,75	7,00	101,60	1.4404	PTFE - FDA	049W60075PT70
						PTFE - USP 121	049W60075PT121
1"	25,40	22,10	9,00	114,30	1.4404	PTFE - FDA	049W60100PT70
						PTFE - USP 121	049W60100PT121
1.1/2"	38,10	34,80	11,50	139,70	1.4404	PTFE - FDA	049W60150PT70
						PTFE - USP 121	049W60150PT121
2"	50,80	47,50	17,00	158,80	1.4404	PTFE - FDA	049W60200PT70
						PTFE - USP 121	049W60200PT121
2.1/2"	63,50	60,20	27,50	212,00	1.4404	PTFE - FDA	049W60250PT70
						PTFE - USP 121	049W60250PT121

Int. finishing: **Ra ≤ 0,4 µm**
Ext. finishing: **Ra ≤ 0,8 µm Mirror Polished**

Max Working Conditions:
10 bar (120 psi) and 150°C (300°F)

Gaskets:
FDA approved PTFE
or USP CLASS VI - 121° PTFE

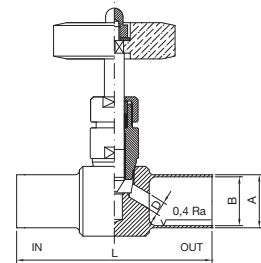

DIN 32676 Butt Weld

Size	Ø A	Ø B	Ø D	Ø L	Valve Material	Gasket Material	Code
DN10	13,00	10,00	5,50	101,60	1.4404	PTFE - FDA	049W6D010PT70
						PTFE - USP 121	049W6D010PT121
DN15	19,00	16,00	7,00	87,00	1.4404	PTFE - FDA	049W6D015PT70
						PTFE - USP 121	049W6D015PT121
DN20	23,00	20,00	7,00	87,00	1.4404	PTFE - FDA	049W6D020PT70
						PTFE - USP 121	049W6D020PT121
DN25	29,00	26,00	9,00	114,30	1.4404	PTFE - FDA	049W6D025PT70
						PTFE - USP 121	049W6D025PT121
DN32	35,00	32,00	11,50	139,70	1.4404	PTFE - FDA	049W6D032PT70
						PTFE - USP 121	049W6D032PT121
DN40	41,00	38,00	11,50	139,70	1.4404	PTFE - FDA	049W6D040PT70
						PTFE - USP 121	049W6D040PT121

Int. finishing: **Ra ≤ 0,4 µm**
Ext. finishing: **Ra ≤ 0,8 µm Mirror Polished**

Max Working Conditions:
10 bar (120 psi) and 150°C (300°F)

Gaskets:
FDA approved PTFE
or USP CLASS VI - 121° PTFE

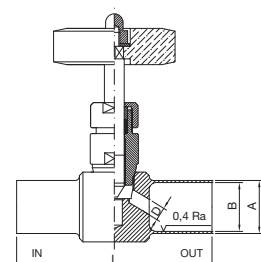



ISO 1127 Butt Weld

Size	Ø A	Ø B	Ø D	Ø L	Valve Material	Gasket Material	Code
DN8	13,50	10,30	5,50	101,60	1.4404	PTFE - FDA	049W6I008 PT70
						PTFE - USP 121	049W6I008 PT121
DN10	17,20	14,00	5,50	101,60	1.4404	PTFE - FDA	049W6I010 PT70
						PTFE - USP 121	049W6I010 PT121
DN15	21,30	18,10	7,00	87,00	1.4404	PTFE - FDA	049W6I015 PT70
						PTFE - USP 121	049W6I015 PT121
DN20	26,90	23,70	9,00	114,30	1.4404	PTFE - FDA	049W6I020 PT70
						PTFE - USP 121	049W6I020 PT121
DN25	33,70	29,70	9,00	114,30	1.4404	PTFE - FDA	049W6I025 PT70
						PTFE - USP 121	049W6I025 PT121
DN32	42,40	38,40	11,50	139,70	1.4404	PTFE - FDA	049W6I032 PT70
						PTFE - USP 121	049W6I032 PT121
DN40	48,30	44,30	11,50	139,70	1.4404	PTFE - FDA	049W6I040 PT70
						PTFE - USP 121	049W6I040 PT121

Int. finishing: **Ra ≤ 0,4 µm**
Ext. finishing: **Ra ≤ 0,8 µm Mirror Polished**

Max Working Conditions:
10 bar (120 psi) and 150°C (300°F)

Gaskets:
FDA approved PTFE
or USP CLASS VI - 121° PTFE

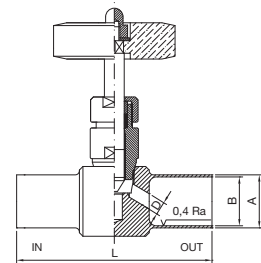

Metric Pipe SP 1.0 mm Butt Weld

Size	Ø A	Ø B	Ø D	Ø L	Valve Material	Gasket Material	Code
DN4	6,00	4,00	4,00	101,60	1.4404	PTFE - FDA	049W6DN04 PT70
						PTFE - USP 121	049W6DN04 PT121
DN6	8,00	6,00	4,00	101,60	1.4404	PTFE - FDA	049W6DN06 PT70
						PTFE - USP 121	049W6DN06 PT121
DN8	10,00	8,00	4,00	101,60	1.4404	PTFE - FDA	049W6DN08 PT70
						PTFE - USP 121	049W6DN08 PT121
DN10	12,00	10,00	5,50	101,60	1.4404	PTFE - FDA	049W6DN10 PT70
						PTFE - USP 121	049W6DN10 PT121
DN12	14,00	12,00	5,50	101,60	1.4404	PTFE - FDA	049W6DN12 PT70
						PTFE - USP 121	049W6DN12 PT121

Int. finishing: **Ra ≤ 0,4 µm**
Ext. finishing: **Ra ≤ 0,8 µm Mirror Polished**

Max Working Conditions:
10 bar (120 psi) and 150°C (300°F)

Gaskets:
FDA approved PTFE
or USP CLASS VI - 121° PTFE

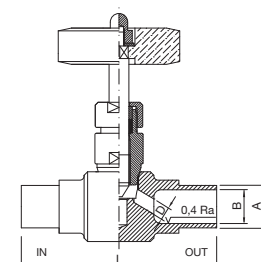

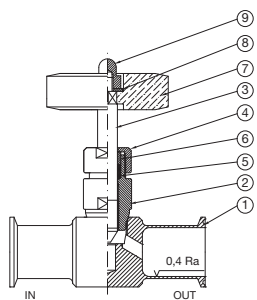

Tri-Clamp

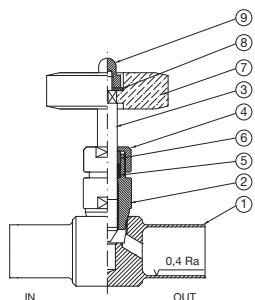

Butt Weld

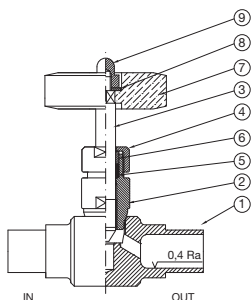

Metric Pipe SP 1.0 mm
Butt Weld

N°	Name	Material
1	Body	AISI 316L
2	Rod Valve Guide	AISI 316L
3	Rod Working Valve	AISI 316L
4	Cap	AISI 316L
5	Gasket	PTFE *
6	Ring	AISI 316L
7	Handle	Bakelite
8	Washer	AISI 304
9	Nut	AISI 304

* FDA approved as standard

N°	Description	ASTM A270 TC	ASTM A270 BW	DIN 32676 TC	DIN 32676 BW	ISO 1127 TC	ISO 1127 BW	Metric BW	Code
4	Cap n° 1 pcs							DN4	0496005004
								DN6	0496005004
								DN8	0496005004
						DN8	DN8	DN10	0496007504
				DN10	DN10	DN10	DN10	DN12	0496007504
		1/4"	1/4"						0496005004
		3/8"	3/8"						0496007504
		1/2"	1/2"						0496007504
		3/4"	3/4"	DN15	DN15	DN15	DN15		0496007504
		1"	1"	DN20	DN20	DN20	DN20		0496010004
5	PTFE - FDA Gasket n° 1 pcs							DN4	053X002505PT70
								DN6	053X002505PT70
								DN8	053X002505PT70
						DN8	DN8	DN10	053X003705PT70
				DN10	DN10	DN10	DN10	DN12	053X003705PT70
		1/4"	1/4"						053X002505PT70
		3/8"	3/8"						053X003705PT70
		1/2"	1/2"						053X003705PT70
		3/4"	3/4"	DN15	DN15	DN15	DN15		053X005005PT70
		1"	1"	DN20	DN20	DN20	DN20		053X007505PT70
5	PTFE - USP 121° Gasket n° 1 pcs							DN4	049X002505PT121
								DN6	049X002505PT121
								DN8	049X002505PT121
						DN8	DN8	DN10	049X003705PT121
				DN10	DN10	DN10	DN10	DN12	049X003705PT121
		1/4"	1/4"						049X002505PT121
		3/8"	3/8"						049X003705PT121
		1/2"	1/2"						049X005005PT121
		3/4"	3/4"	DN15	DN15	DN15	DN15		049X007505PT121
		1"	1"	DN20	DN20	DN20	DN20		049X010005PT121
1.1/2"	1.1/2"	DN25	DN25	DN25	DN25		049X015005PT121		
2"	2"	DN32	DN32	DN32	DN32		049X015005PT121		
2.1/2"	2.1/2"	DN40	DN40	DN40	DN40		049X025005PT121		

N°	Description	ASTM A270 TC	ASTM A270 BW	DIN 32676 TC	DIN 32676 BW	ISO 1127 TC	ISO 1127 BW	Metric BW	Code
6	Ring n° 1 pcs							DN4	0536002506
								DN6	0536002506
								DN8	0536002506
						DN8	DN8	DN10	0536003706
				DN10	DN10	DN10	DN10	DN12	0536003706
		1/4"	1/4"						0536002506
		3/8"	3/8"						0536003706
		1/2"	1/2"						0536003706
		3/4"	3/4"	DN15	DN15	DN15	DN15		0536005006
		1"	1"	DN20	DN20	DN20	DN20		0536007506
		1.1/2"	1.1/2"	DN25	DN25	DN25	DN25		0536010006
		2"	2"	DN32	DN32	DN32	DN32		0536010006
2.1/2"	2.1/2"	DN40	DN40	DN40	DN40		0536020006		
7	Handle n° 1 pcs							DN4	VZ.42-5X5
								DN6	VZ.42-5X5
								DN8	VZ.42-5X5
						DN8	DN8	DN10	VCR.192_50-6X6
				DN10	DN10	DN10	DN10	DN12	VCR.192_50-6X6
		1/4"	1/4"						VZ.42-5X5
		3/8"	3/8"						VCR.192_50-6X6
		1/2"	1/2"						VCR.192_50-6X6
		3/4"	3/4"	DN15	DN15	DN15	DN15		VCR.192_50-6X6
		1"	1"	DN20 - DN25	DN20 - DN25	DN20 - DN25	DN20 - DN25		VCR.192_60-8X8
		1.1/2"	1.1/2"						VCR.192_70-8X8
		2"	2"	DN32	DN32	DN32	DN32		VCR.192_70-8X8
2.1/2"	2.1/2"	DN40	DN40	DN40	DN40		VCR.192_100-10X10		
8	Washer n° 1 pcs							DN4	WA205.30-12.00-01.00
								DN6	WA205.30-12.00-01.00
								DN8	WA205.30-12.00-01.00
						DN8	DN8	DN10	WA206.50-11.70-01.50
				DN10	DN10	DN10	DN10	DN12	WA206.50-11.70-01.50
		1/4"	1/4"						WA205.30-12.00-01.00
		3/8"	3/8"						WA206.50-11.70-01.50
		1/2"	1/2"						WA206.50-11.70-01.50
		3/4"	3/4"	DN15	DN15	DN15	DN15		WA206.50-11.70-01.50
		1"	1"	DN20	DN20	DN20	DN20		WA208.50-15.70-01.50
		1.1/2"	1.1/2"	DN25	DN25	DN25	DN25		WA208.50-15.70-01.50
		2"	2"	DN32	DN32	DN32	DN32		WA208.50-15.70-01.50
2.1/2"	2.1/2"	DN40	DN40	DN40	DN40		WA208.50-15.70-01.50		
9	Nut n° 1 pcs							DN4	BN-A2-M05
								DN6	BN-A2-M05
								DN8	BN-A2-M05
						DN8	DN8	DN10	BN-A2-M06
				DN10	DN10	DN10	DN10	DN12	BN-A2-M06
		1/4"	1/4"						BN-A2-M05
		3/8"	3/8"						BN-A2-M06
		1/2"	1/2"						BN-A2-M06
		3/4"	3/4"	DN15	DN15	DN15	DN15		BN-A2-M06
		1"	1"	DN20	DN20	DN20	DN20		BN-A2-M08
		1.1/2"	1.1/2"	DN25	DN25	DN25	DN25		BN-A2-M08
		2"	2"	DN32	DN32	DN32	DN32		BN-A2-M08
2.1/2"	2.1/2"	DN40	DN40	DN40	DN40		BN-A2-M08		



Female Gas Threaded BSPP

Size	Ø A	H	L	Valve Material	Gasket Material	Code
1/4"	4,00	78,00	45,00	1.4404	PTFE - FDA	053Z60025PT70
3/8"	5,50	92,00	52,00	1.4404	PTFE - FDA	053Z60037PT70
1/2"	7,00	106,00	61,00	1.4404	PTFE - FDA	053Z60050PT70
3/4"	9,00	119,00	68,00	1.4404	PTFE - FDA	053Z60075PT70
1"	11,50	135,00	86,00	1.4404	PTFE - FDA	053Z60100PT70
1.1/2"	17,00	150,00	120,00	1.4404	PTFE - FDA	053Z60150PT70
2"	27,50	224,00	224,00	1.4404	PTFE - FDA	053Z60200PT70

Int. finishing: **Ra ≤ 1,6 µm**
Ext. finishing: **Ra ≤ 1,6 µm**

Max Working Conditions:
60 bar and (870 psi) and 150°C (300°F)

Spare Parts

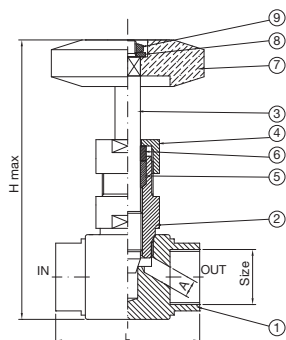

N°	Name	Material
1	Body	AISI 316L
2	Rod Valve Guide	AISI 316L
3	Rod Working Valve	AISI 316L
4	Cap	AISI 316L
5	Gasket	PTFE
6	Ring	AISI 316L
7	Handle	Bakelite
8	Washer	AISI 304
9	Nut	AISI 304

N°	Description	Valve size	Code
4	Cap n° 1 pcs	1/4"	0536002504
		3/8"	0536003704
		1/2"	0536005004
		3/4"	0536007504
		1"	0536010004
		1.1/2"	0536010004
		2"	0536020004
5	PTFE - FDA Gasket n° 1 pcs	1/4"	053X002505PT70
		3/8"	053X003705PT70
		1/2"	053X005005PT70
		3/4"	053X007505PT70
		1"	053X010005PT70
		1.1/2"	053X010005PT70
		2"	053X020005PT70
6	Ring n° 1 pcs	1/4"	0536002506
		3/8"	0536003706
		1/2"	0536005006
		3/4"	0536007506
		1"	0536010006
		1.1/2"	0536010006
		2"	0536020006

N°	Description	Valve size	Code
7	Handle n° 1 pcs	1/4"	VZ.42-5X5
		3/8"	VCR.192_50-6X6
		1/2"	VCR.192_50-6X6
		3/4"	VCR.192_60-8X8
		1"	VCR.192_70-8X8
		1.1/2"	VCR.192_70-8X8
		2"	VCR.192_100-10X10
8	Washer n° 1 pcs	1/4"	-
		3/8"	-
		1/2"	-
		3/4"	WA208.50-15.70-01.50
		1"	WA208.50-15.70-01.50
		1.1/2"	WA208.50-15.70-01.50
		2"	WA208.50-15.70-01.50
9	Nut n° 1 pcs	1/4"	N-A2-M05-H040
		3/8"	N-A2-M06-H050
		1/2"	N-A2-M06-H050
		3/4"	N-A2-M08-H065
		1"	N-A2-M08-H065
		1.1/2"	N-A2-M08-H065
		2"	N-A2-M08-H065



Male Gas Threaded BSPP

Size	L	H	Ø F	Valve Material	Gasket Material	Code
3/8"	144,00	48,00	40,00	1.4404	PTFE - FDA + FPM/FKM	054Z60037PT70
1/2"	144,00	48,00	40,00	1.4404	PTFE - FDA + FPM/FKM	054Z60050PT70

Int. finishing: **Ra ≤ 1,6 µm**
Ext. finishing: **Ra ≤ 1,6 µm**

Max Working Conditions:
10 bar (120 psi) and 150°C (300°F)

Spare Parts

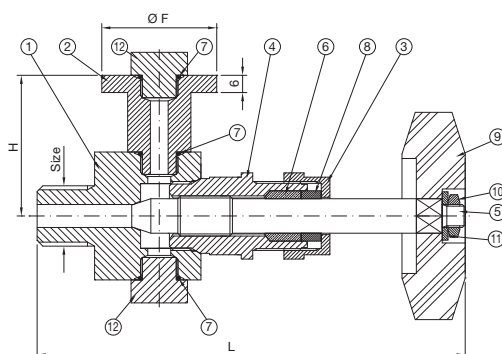

N°	Name	Material
1	Body	AISI 316L
2	Flange	AISI 316L
3	Cap	AISI 316L
4	Rod Valve Guide	AISI 316L
5	Rod Working Valve	AISI 316L
6	Piston Gasket	PTFE
7	O-Ring 3043	FPM/FKM
8	Stainless-steel Ring	AISI 316L
9	Handle	BAKELITE
10	M6 Nut	AISI 304
11	M6 Washer	AISI 304
12	1/4" Hexagonal Cap	AISI 316L

N°	Description	Valve size	Code
2	Flange - n° 1 pcs	all sizes	0546000002
3	Cap - n° 1 pcs	all sizes	0536005004
6	Piston Gasket - PTFE - FDA - n° 1 pcs	all sizes	053X005005PT70
7	O-Ring 3043 FPM/FKM - n° 5 pcs	all sizes	0546X000007V
8	Ring - n° 1 pcs	all sizes	0536005006
9	Handle - n° 1 pcs	all sizes	VCR.192_50-6X6
10	Nut - n° 1 pcs	all sizes	N-A2-M06
11	Washer - n° 1 pcs	all sizes	WA206.50-11.70-01.50
12	Hexagonal Nut - n° 1 pcs	all sizes	0546000012