



ASTM A270 Butt Weld

Size	Ø A	Ø B	Ø D	Ø L	Valve Material	Gasket Material	Code
1/4"	6,35	4,57	4,00	101,60	1.4404	PTFE - FDA	049W60025PT70
						PTFE - USP 121	049W60025PT121
3/8"	9,53	7,75	5,50	101,60	1.4404	PTFE - FDA	049W60037PT70
						PTFE - USP 121	049W60037PT121
1/2"	12,7	9,40	5,50	101,60	1.4404	PTFE - FDA	049W60050PT70
						PTFE - USP 121	049W60050PT121
3/4"	19,05	15,75	7,00	101,60	1.4404	PTFE - FDA	049W60075PT70
						PTFE - USP 121	049W60075PT121
1"	25,40	22,10	9,00	114,30	1.4404	PTFE - FDA	049W60100PT70
						PTFE - USP 121	049W60100PT121
1.1/2"	38,10	34,80	11,50	139,70	1.4404	PTFE - FDA	049W60150PT70
						PTFE - USP 121	049W60150PT121
2"	50,80	47,50	17,00	158,80	1.4404	PTFE - FDA	049W60200PT70
						PTFE - USP 121	049W60200PT121
2.1/2"	63,50	60,20	27,50	212,00	1.4404	PTFE - FDA	049W60250PT70
						PTFE - USP 121	049W60250PT121

Int. finishing: **Ra ≤ 0,4 µm**
Ext. finishing: **Ra ≤ 0,8 µm Mirror Polished**

Max Working Conditions:
10 bar (120 psi) and 150°C (300°F)

Gaskets:
FDA approved PTFE
or USP CLASS VI - 121° PTFE

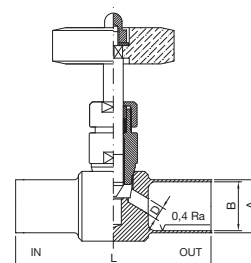

DIN 32676 Butt Weld

Size	Ø A	Ø B	Ø D	Ø L	Valve Material	Gasket Material	Code
DN10	13,00	10,00	5,50	101,60	1.4404	PTFE - FDA	049W6D010PT70
						PTFE - USP 121	049W6D010PT121
DN15	19,00	16,00	7,00	87,00	1.4404	PTFE - FDA	049W6D015PT70
						PTFE - USP 121	049W6D015PT121
DN20	23,00	20,00	7,00	87,00	1.4404	PTFE - FDA	049W6D020PT70
						PTFE - USP 121	049W6D020PT121
DN25	29,00	26,00	9,00	114,30	1.4404	PTFE - FDA	049W6D025PT70
						PTFE - USP 121	049W6D025PT121
DN32	35,00	32,00	11,50	139,70	1.4404	PTFE - FDA	049W6D032PT70
						PTFE - USP 121	049W6D032PT121
DN40	41,00	38,00	11,50	139,70	1.4404	PTFE - FDA	049W6D040PT70
						PTFE - USP 121	049W6D040PT121

Int. finishing: **Ra ≤ 0,4 µm**
Ext. finishing: **Ra ≤ 0,8 µm Mirror Polished**

Max Working Conditions:
10 bar (120 psi) and 150°C (300°F)

Gaskets:
FDA approved PTFE
or USP CLASS VI - 121° PTFE

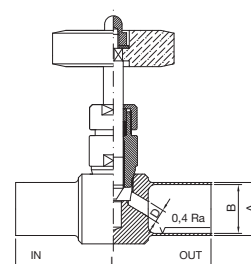



ISO 1127 Butt Weld

Size	Ø A	Ø B	Ø D	Ø L	Valve Material	Gasket Material	Code
DN8	13,50	10,30	5,50	101,60	1.4404	PTFE - FDA	049W6I008 PT70
						PTFE - USP 121	049W6I008 PT121
DN10	17,20	14,00	5,50	101,60	1.4404	PTFE - FDA	049W6I010 PT70
						PTFE - USP 121	049W6I010 PT121
DN15	21,30	18,10	7,00	87,00	1.4404	PTFE - FDA	049W6I015 PT70
						PTFE - USP 121	049W6I015 PT121
DN20	26,90	23,70	9,00	114,30	1.4404	PTFE - FDA	049W6I020 PT70
						PTFE - USP 121	049W6I020 PT121
DN25	33,70	29,70	9,00	114,30	1.4404	PTFE - FDA	049W6I025 PT70
						PTFE - USP 121	049W6I025 PT121
DN32	42,40	38,40	11,50	139,70	1.4404	PTFE - FDA	049W6I032 PT70
						PTFE - USP 121	049W6I032 PT121
DN40	48,30	44,30	11,50	139,70	1.4404	PTFE - FDA	049W6I040 PT70
						PTFE - USP 121	049W6I040 PT121

Int. finishing: **Ra ≤ 0,4 µm**
Ext. finishing: **Ra ≤ 0,8 µm Mirror Polished**

Max Working Conditions:
10 bar (120 psi) and 150°C (300°F)

Gaskets:
FDA approved PTFE
or USP CLASS VI - 121° PTFE

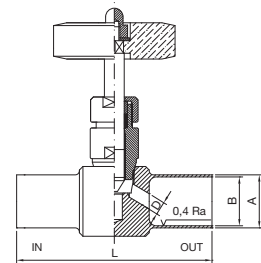

Metric Pipe SP 1.0 mm Butt Weld

Size	Ø A	Ø B	Ø D	Ø L	Valve Material	Gasket Material	Code
DN4	6,00	4,00	4,00	101,60	1.4404	PTFE - FDA	049W6DN04 PT70
						PTFE - USP 121	049W6DN04 PT121
DN6	8,00	6,00	4,00	101,60	1.4404	PTFE - FDA	049W6DN06 PT70
						PTFE - USP 121	049W6DN06 PT121
DN8	10,00	8,00	4,00	101,60	1.4404	PTFE - FDA	049W6DN08 PT70
						PTFE - USP 121	049W6DN08 PT121
DN10	12,00	10,00	5,50	101,60	1.4404	PTFE - FDA	049W6DN10 PT70
						PTFE - USP 121	049W6DN10 PT121
DN12	14,00	12,00	5,50	101,60	1.4404	PTFE - FDA	049W6DN12 PT70
						PTFE - USP 121	049W6DN12 PT121

Int. finishing: **Ra ≤ 0,4 µm**
Ext. finishing: **Ra ≤ 0,8 µm Mirror Polished**

Max Working Conditions:
10 bar (120 psi) and 150°C (300°F)

Gaskets:
FDA approved PTFE
or USP CLASS VI - 121° PTFE

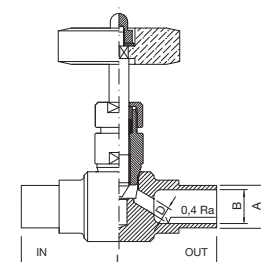

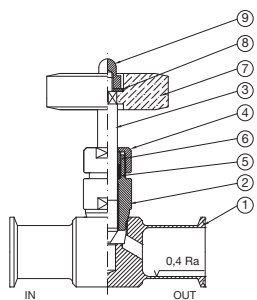

Tri-Clamp

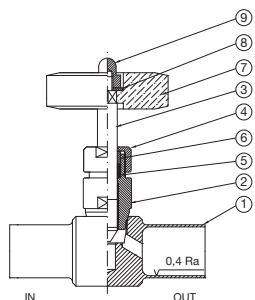

Butt Weld

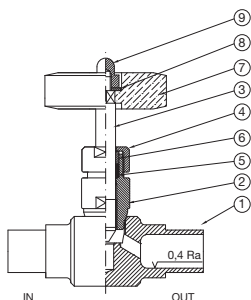

Metric Pipe SP 1.0 mm
Butt Weld

N°	Name	Material
1	Body	AISI 316L
2	Rod Valve Guide	AISI 316L
3	Rod Working Valve	AISI 316L
4	Cap	AISI 316L
5	Gasket	PTFE *
6	Ring	AISI 316L
7	Handle	Bakelite
8	Washer	AISI 304
9	Nut	AISI 304

* FDA approved as standard

N°	Description	ASTM A270 TC	ASTM A270 BW	DIN 32676 TC	DIN 32676 BW	ISO 1127 TC	ISO 1127 BW	Metric BW	Code
4	Cap n° 1 pcs							DN4	0496005004
								DN6	0496005004
								DN8	0496005004
						DN8	DN8	DN10	0496007504
				DN10	DN10	DN10	DN10	DN12	0496007504
		1/4"	1/4"						0496005004
		3/8"	3/8"						0496007504
		1/2"	1/2"						0496007504
		3/4"	3/4"	DN15	DN15	DN15	DN15		0496007504
		1"	1"	DN20	DN20	DN20	DN20		0496010004
5	PTFE - FDA Gasket n° 1 pcs							DN4	053X002505PT70
								DN6	053X002505PT70
								DN8	053X002505PT70
						DN8	DN8	DN10	053X003705PT70
				DN10	DN10	DN10	DN10	DN12	053X003705PT70
		1/4"	1/4"						053X002505PT70
		3/8"	3/8"						053X003705PT70
		1/2"	1/2"						053X003705PT70
		3/4"	3/4"	DN15	DN15	DN15	DN15		053X005005PT70
		1"	1"	DN20	DN20	DN20	DN20		053X007505PT70
5	PTFE - USP 121° Gasket n° 1 pcs							DN4	049X002505PT121
								DN6	049X002505PT121
								DN8	049X002505PT121
						DN8	DN8	DN10	049X003705PT121
				DN10	DN10	DN10	DN10	DN12	049X003705PT121
		1/4"	1/4"						049X002505PT121
		3/8"	3/8"						049X003705PT121
		1/2"	1/2"						049X005005PT121
		3/4"	3/4"	DN15	DN15	DN15	DN15		049X007505PT121
		1"	1"	DN20	DN20	DN20	DN20		049X010005PT121
1.1/2"	1.1/2"	DN25	DN25	DN25	DN25		049X015005PT121		
2"	2"	DN32	DN32	DN32	DN32		049X015005PT121		
2.1/2"	2.1/2"	DN40	DN40	DN40	DN40		049X025005PT121		

N°	Description	ASTM A270 TC	ASTM A270 BW	DIN 32676 TC	DIN 32676 BW	ISO 1127 TC	ISO 1127 BW	Metric BW	Code
6	Ring n° 1 pcs							DN4	0536002506
								DN6	0536002506
								DN8	0536002506
						DN8	DN8	DN10	0536003706
				DN10	DN10	DN10	DN10	DN12	0536003706
		1/4"	1/4"						0536002506
		3/8"	3/8"						0536003706
		1/2"	1/2"						0536003706
		3/4"	3/4"	DN15	DN15	DN15	DN15		0536005006
		1"	1"	DN20	DN20	DN20	DN20		0536007506
		1.1/2"	1.1/2"	DN25	DN25	DN25	DN25		0536010006
		2"	2"	DN32	DN32	DN32	DN32		0536010006
2.1/2"	2.1/2"	DN40	DN40	DN40	DN40		0536020006		
7	Handle n° 1 pcs							DN4	VZ.42-5X5
								DN6	VZ.42-5X5
								DN8	VZ.42-5X5
						DN8	DN8	DN10	VCR.192_50-6X6
				DN10	DN10	DN10	DN10	DN12	VCR.192_50-6X6
		1/4"	1/4"						VZ.42-5X5
		3/8"	3/8"						VCR.192_50-6X6
		1/2"	1/2"						VCR.192_50-6X6
		3/4"	3/4"	DN15	DN15	DN15	DN15		VCR.192_50-6X6
		1"	1"	DN20 - DN25	DN20 - DN25	DN20 - DN25	DN20 - DN25		VCR.192_60-8X8
		1.1/2"	1.1/2"						VCR.192_70-8X8
		2"	2"	DN32	DN32	DN32	DN32		VCR.192_70-8X8
2.1/2"	2.1/2"	DN40	DN40	DN40	DN40		VCR.192_100-10X10		
8	Washer n° 1 pcs							DN4	WA205.30-12.00-01.00
								DN6	WA205.30-12.00-01.00
								DN8	WA205.30-12.00-01.00
						DN8	DN8	DN10	WA206.50-11.70-01.50
				DN10	DN10	DN10	DN10	DN12	WA206.50-11.70-01.50
		1/4"	1/4"						WA205.30-12.00-01.00
		3/8"	3/8"						WA206.50-11.70-01.50
		1/2"	1/2"						WA206.50-11.70-01.50
		3/4"	3/4"	DN15	DN15	DN15	DN15		WA206.50-11.70-01.50
		1"	1"	DN20	DN20	DN20	DN20		WA208.50-15.70-01.50
		1.1/2"	1.1/2"	DN25	DN25	DN25	DN25		WA208.50-15.70-01.50
		2"	2"	DN32	DN32	DN32	DN32		WA208.50-15.70-01.50
2.1/2"	2.1/2"	DN40	DN40	DN40	DN40		WA208.50-15.70-01.50		
9	Nut n° 1 pcs							DN4	BN-A2-M05
								DN6	BN-A2-M05
								DN8	BN-A2-M05
						DN8	DN8	DN10	BN-A2-M06
				DN10	DN10	DN10	DN10	DN12	BN-A2-M06
		1/4"	1/4"						BN-A2-M05
		3/8"	3/8"						BN-A2-M06
		1/2"	1/2"						BN-A2-M06
		3/4"	3/4"	DN15	DN15	DN15	DN15		BN-A2-M06
		1"	1"	DN20	DN20	DN20	DN20		BN-A2-M08
		1.1/2"	1.1/2"	DN25	DN25	DN25	DN25		BN-A2-M08
		2"	2"	DN32	DN32	DN32	DN32		BN-A2-M08
2.1/2"	2.1/2"	DN40	DN40	DN40	DN40		BN-A2-M08		