

// Wide range of sampling
solutions adaptable
to any connection



SIDE SAMPLING VALVES



ART. 044
90° O-Ring
Sampling Valves
P. 032



ART. 045
180° O-Ring
Sampling Valves
P. 040



ART. 090
30° O-Ring
Sampling Valves
P. 042



ART. 091
Ingold O-Ring
Sampling Valves
P. 050



ART. 023
90° Needle
Sampling Valves
P. 052



ART. 022
90° Needle Sampling Valves
Gas Threaded
P. 053



ART. 041
180° Needle
Sampling Valves
P. 054



ART. 033
180° Needle Sampling Valves
Gas Threaded
P. 055



ART. 344
90° O-Ring
Sampling Valves
P. 056



ART. 390
30° O-Ring
Sampling Valves
P. 057

Characteristics. Side pipe sanitary sampling valves are designed for sampling of liquids on pharmaceutical, chemical, F&B and cosmetics products. O-Ring closing system for Art. 044, Art. 045, Art. 090 and Art. 091, metal closing system for Art. 022, Art. 023, Art. 033, Art. 041.

Documentation. Laser marking for traceability and validation processes. Material 3.1 certificates, FDA or USP, internal surface finishing check.

ART. 044

SIDE SAMPLING VALVES

90° O-RING SAMPLING VALVES

Characteristics: Designed for sampling of liquids on pharmaceutical, chemical, F&B and cosmetics products. O-Ring closing system.

Documentation: Laser marking for traceability and validation processes. Material 3.1 certificates, FDA or USP, internal surface finishing check as standard.



1 HOSE BARB OUTLET



ART. 044/A
P. 033

1 TRI-CLAMP OUTLET



ART. 044/B
P. 032

1 HOSE BARB OUTLET
+ 1 CIP HOSE BARB INLET



ART. 044/C
P. 035

1 HOSE BARB OUTLET
+ 1 CIP TRI-CLAMP INLET



ART. 044/D
P. 036

1 TRI-CLAMP OUTLET
+ 1 CIP TRI-CLAMP INLET



ART. 044/E
P. 037

1 LUER OUTLET



ART. 044/G
P. 038

1 LUER OUTLET
+ 1 CIP TRI-CLAMP INLET



ART. 044/H
P. 039



ASTM A270 Tri-Clamp - Flange design according to ASME-BPE
DIN 32676 Tri-Clamp
ISO 1127 Tri-Clamp

Ø A	L	Valve Material	O-Rings Material	Code
25,00	61,50	1.4404	FPM/FKM	044A6TC25V
			EPDM	044A6TC25EP
			SILICONE FDA	044A6TC25SIF
			SILICONE USP 121	044A6TC25SI121
34,00	61,50	1.4404	FPM/FKM	044A6TC34V
			EPDM	044A6TC34EP
			SILICONE FDA	044A6TC34SIF
			SILICONE USP 121	044A6TC34SI121
50,50	68,00	1.4404	FPM/FKM	044A6TC50V
			EPDM	044A6TC50EP
			SILICONE FDA	044A6TC50SIF
			SILICONE USP 121	044A6TC50SI121

Int. finishing: **Ra ≤ 0,4 µm**
Ext. finishing: **Ra ≤ 0,8 µm Mirror Polished**

Max Working Conditions:
12 bar (170 psi) and 150°C (300°F)

Installation:
Horizontal installation recommended

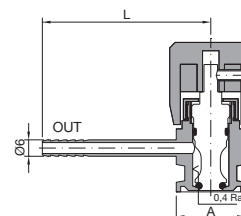

Spare parts

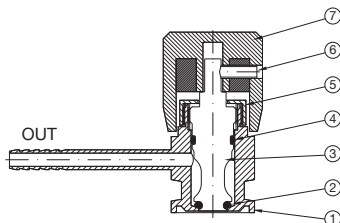

N°	Name	Material
1	Body	AISI 316L
2	O-Ring 3021	FPM/FKM or EPDM or SILICONE FDA or SILICONE USP 121
3	Piston	AISI 316L
4	O-Ring 2037	FPM/FKM or EPDM or SILICONE FDA or SILICONE USP 121
5	Ring	AISI 316L
6	Grub Screw M4	AISI 304
7	Handle	PTFE + INOX

N°	Description	Valve size	Code
2+4	O-Ring Kit 3021 / 2037 FPM/FKM - n° 10 + 10 pcs	all sizes	ORSV1010V
2+4	O-Ring Kit 3021 / 2037 EPDM - n° 10 + 10 pcs	all sizes	ORSV1010EP
2+4	O-Ring Kit 3021 / 2037 SILICONE FDA - n° 10 + 10 pcs	all sizes	ORSV1010SIF
2+4	O-Ring Kit 3021 / 2037 SILICONE USP 121° - n° 10 + 10 pcs	all sizes	ORSV1010SI121
5	Ring - n° 1 pcs	all sizes	AAAA0090
6	Grub Screw M4 Kit - n° 10 pcs	all sizes	ORSVM4X10
7	Handle PTFE + INOX - n° 1 pcs	all sizes	ORSVHA1



ASTM A270 Tri-Clamp - Flange design according to ASME-BPE
DIN 32676 Tri-Clamp
ISO 1127 Tri-Clamp

Ø A	L	Valve Material	O-Rings Material	Code
25,00	51,50	1.4404	FPM/FKM	044B6TC25V
			EPDM	044B6TC25EP
			SILICONE FDA	044B6TC25SIF
			SILICONE USP 121	044B6TC25SI121
34,00	51,50	1.4404	FPM/FKM	044B6TC34V
			EPDM	044B6TC34EP
			SILICONE FDA	044B6TC34SIF
			SILICONE USP 121	044B6TC34SI121
50,50	58,00	1.4404	FPM/FKM	044B6TC50V
			EPDM	044B6TC50EP
			SILICONE FDA	044B6TC50SIF
			SILICONE USP 121	044B6TC50SI121

Int. finishing: **Ra ≤ 0,4 µm**
Ext. finishing: **Ra ≤ 0,8 µm Mirror Polished**

Max Working Conditions:
12 bar (170 psi) and 150°C (300°F)

Installation:
Horizontal installation recommended

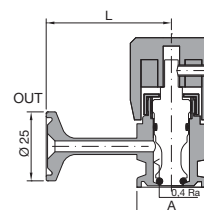

Spare parts

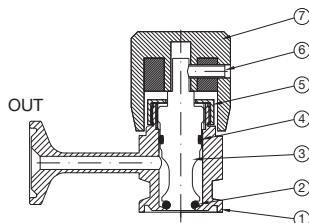

N°	Name	Material
1	Body	AISI 316L
2	O-Ring 3021	FPM/FKM or EPDM or SILICONE FDA or SILICONE USP 121
3	Piston	AISI 316L
4	O-Ring 2037	FPM/FKM or EPDM or SILICONE FDA or SILICONE USP 121
5	Ring	AISI 316L
6	Grub Screw M4	AISI 304
7	Handle	PTFE + INOX

N°	Description	Valve size	Code
2+4	O-Ring Kit 3021 / 2037 FPM/FKM - n° 10 + 10 pcs	all sizes	ORSV1010V
2+4	O-Ring Kit 3021 / 2037 EPDM - n° 10 + 10 pcs	all sizes	ORSV1010EP
2+4	O-Ring Kit 3021 / 2037 SILICONE FDA - n° 10 + 10 pcs	all sizes	ORSV1010SIF
2+4	O-Ring Kit 3021 / 2037 SILICONE USP 121° - n° 10 + 10 pcs	all sizes	ORSV1010SI121
5	Ring - n° 1 pcs	all sizes	AAAA0090
6	Grub Screw M4 Kit - n° 10 pcs	all sizes	ORSVM4X10
7	Handle PTFE + INOX - n° 1 pcs	all sizes	ORSVHA1



ASTM A270 Tri-Clamp - Flange design according to ASME-BPE
DIN 32676 Tri-Clamp
ISO 1127 Tri-Clamp

Ø A	L	Valve Material	O-Rings Material	Code
25,00	61,50	1.4404	FPM/FKM	044C6TC25V
			EPDM	044C6TC25EP
			SILICONE FDA	044C6TC25SIF
			SILICONE USP 121	044C6TC25SI121
34,00	61,50	1.4404	FPM/FKM	044C6TC34V
			EPDM	044C6TC34EP
			SILICONE FDA	044C6TC34SIF
			SILICONE USP 121	044C6TC34SI121
50,50	68,00	1.4404	FPM/FKM	044C6TC50V
			EPDM	044C6TC50EP
			SILICONE FDA	044C6TC50SIF
			SILICONE USP 121	044C6TC50SI121

Int. finishing: **Ra ≤ 0,4 µm**
Ext. finishing: **Ra ≤ 0,8 µm Mirror Polished**

Max Working Conditions:
12 bar (170 psi) and 150°C (300°F)

Installation:
Horizontal installation recommended

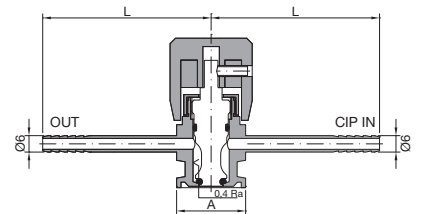

Spare parts

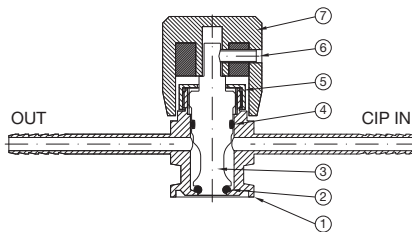

N°	Name	Material
1	Body	AISI 316L
2	O-Ring 3021	FPM/FKM or EPDM or SILICONE FDA or SILICONE USP 121
3	Piston	AISI 316L
4	O-Ring 2037	FPM/FKM or EPDM or SILICONE FDA or SILICONE USP 121
5	Ring	AISI 316L
6	Grub Screw M4	AISI 304
7	Handle	PTFE + INOX

N°	Description	Valve size	Code
2+4	O-Ring Kit 3021 / 2037 FPM/FKM - n° 10 + 10 pcs	all sizes	ORSV1010V
2+4	O-Ring Kit 3021 / 2037 EPDM - n° 10 + 10 pcs	all sizes	ORSV1010EP
2+4	O-Ring Kit 3021 / 2037 SILICONE FDA - n° 10 + 10 pcs	all sizes	ORSV1010SIF
2+4	O-Ring Kit 3021 / 2037 SILICONE USP 121° - n° 10 + 10 pcs	all sizes	ORSV1010SI121
5	Ring - n° 1 pcs	all sizes	AAAA0090
6	Grub Screw M4 Kit - n° 10 pcs	all sizes	ORSVM4X10
7	Handle PTFE + INOX - n° 1 pcs	all sizes	ORSVHA1



ASTM A270 Tri-Clamp - Flange design according to ASME-BPE
DIN 32676 Tri-Clamp
ISO 1127 Tri-Clamp

Ø A	L1	L2	Valve Material	O-Rings Material	Code
25,00	61,50	51,50	1.4404	FPM/FKM	044D6TC25V
				EPDM	044D6TC25EP
				SILICONE FDA	044D6TC25SIF
				SILICONE USP 121	044D6TC25SI121
34,00	61,50	51,50	1.4404	FPM/FKM	044D6TC34V
				EPDM	044D6TC34EP
				SILICONE FDA	044D6TC34SIF
				SILICONE USP 121	044D6TC34SI121
50,50	68,00	58,00	1.4404	FPM/FKM	044D6TC50V
				EPDM	044D6TC50EP
				SILICONE FDA	044D6TC50SIF
				SILICONE USP 121	044D6TC50SI121

Int. finishing: **Ra ≤ 0,4 µm**
Ext. finishing: **Ra ≤ 0,8 µm Mirror Polished**

Max Working Conditions:
12 bar (170 psi) and 150°C (300°F)

Installation:
Horizontal installation recommended

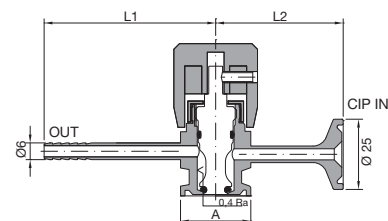

Spare parts

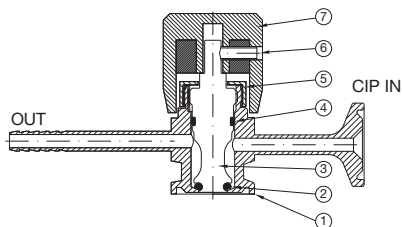

N°	Name	Material
1	Body	AISI 316L
2	O-Ring 3021	FPM/FKM or EPDM or SILICONE FDA or SILICONE USP 121
3	Piston	AISI 316L
4	O-Ring 2037	FPM/FKM or EPDM or SILICONE FDA or SILICONE USP 121
5	Ring	AISI 316L
6	Grub Screw M4	AISI 304
7	Handle	PTFE + INOX

N°	Description	Valve size	Code
2+4	O-Ring Kit 3021 / 2037 FPM/FKM - n° 10 + 10 pcs	all sizes	ORSV1010V
2+4	O-Ring Kit 3021 / 2037 EPDM - n° 10 + 10 pcs	all sizes	ORSV1010EP
2+4	O-Ring Kit 3021 / 2037 SILICONE FDA - n° 10 + 10 pcs	all sizes	ORSV1010SIF
2+4	O-Ring Kit 3021 / 2037 SILICONE USP 121° - n° 10 + 10 pcs	all sizes	ORSV1010SI121
5	Ring - n° 1 pcs	all sizes	AAAA0090
6	Grub Screw M4 Kit - n° 10 pcs	all sizes	ORSVM4X10
7	Handle PTFE + INOX - n° 1 pcs	all sizes	ORSVHA1



ASTM A270 Tri-Clamp - Flange design according to ASME-BPE
DIN 32676 Tri-Clamp
ISO 1127 Tri-Clamp

Ø A	L	Valve Material	O-Rings Material	Code
25,00	51,50	1.4404	FPM/FKM	044E6TC25V
			EPDM	044E6TC25EP
			SILICONE FDA	044E6TC25SIF
			SILICONE USP 121	044E6TC25SI121
34,00	51,50	1.4404	FPM/FKM	044E6TC34V
			EPDM	044E6TC34EP
			SILICONE FDA	044E6TC34SIF
			SILICONE USP 121	044E6TC34SI121
50,50	58,00	1.4404	FPM/FKM	044E6TC50V
			EPDM	044E6TC50EP
			SILICONE FDA	044E6TC50SIF
			SILICONE USP 121	044E6TC50SI121

Int. finishing: **Ra ≤ 0,4 µm**
Ext. finishing: **Ra ≤ 0,8 µm Mirror Polished**

Max Working Conditions:
12 bar (170 psi) and 150°C (300°F)

Installation:
Horizontal installation recommended

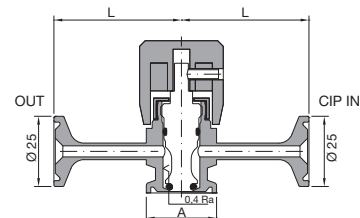

Spare parts

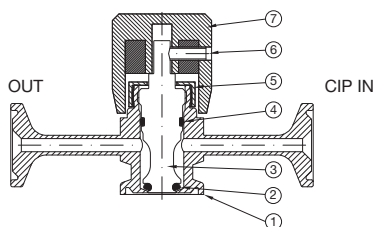

N°	Name	Material
1	Body	AISI 316L
2	O-Ring 3021	FPM/FKM or EPDM or SILICONE FDA or SILICONE USP 121
3	Piston	AISI 316L
4	O-Ring 2037	FPM/FKM or EPDM or SILICONE FDA or SILICONE USP 121
5	Ring	AISI 316L
6	Grub Screw M4	AISI 304
7	Handle	PTFE + INOX

N°	Description	Valve size	Code
2+4	O-Ring Kit 3021 / 2037 FPM/FKM - n° 10 + 10 pcs	all sizes	ORSV1010V
2+4	O-Ring Kit 3021 / 2037 EPDM - n° 10 + 10 pcs	all sizes	ORSV1010EP
2+4	O-Ring Kit 3021 / 2037 SILICONE FDA - n° 10 + 10 pcs	all sizes	ORSV1010SIF
2+4	O-Ring Kit 3021 / 2037 SILICONE USP 121° - n° 10 + 10 pcs	all sizes	ORSV1010SI121
5	Ring - n° 1 pcs	all sizes	AAAA0090
6	Grub Screw M4 Kit - n° 10 pcs	all sizes	ORSVM4X10
7	Handle PTFE + INOX - n° 1 pcs	all sizes	ORSVHA1



ASTM A270 Tri-Clamp - Flange design according to ASME-BPE
DIN 32676 Tri-Clamp
ISO 1127 Tri-Clamp

Ø A	L	Valve Material	O-Rings Material	Code
25,00	40,00	1.4404	FPM/FKM	044G6TC25V
			EPDM	044G6TC25EP
			SILICONE FDA	044G6TC25SIF
			SILICONE USP 121	044G6TC25SI121
34,00	40,00	1.4404	FPM/FKM	044G6TC34V
			EPDM	044G6TC34EP
			SILICONE FDA	044G6TC34SIF
			SILICONE USP 121	044G6TC34SI121
50,50	46,50	1.4404	FPM/FKM	044G6TC50V
			EPDM	044G6TC50EP
			SILICONE FDA	044G6TC50SIF
			SILICONE USP 121	044G6TC50SI121

Int. finishing: **Ra ≤ 0,4 µm**
Ext. finishing: **Ra ≤ 0,8 µm Mirror Polished**

Max Working Conditions:
12 bar (170 psi) and 150°C (300°F)

Installation:
Horizontal installation recommended

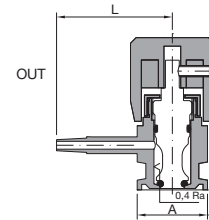

Spare parts

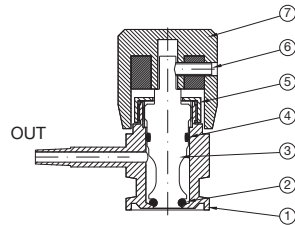

N°	Name	Material
1	Body	AISI 316L
2	O-Ring 3021	FPM/FKM or EPDM or SILICONE FDA or SILICONE USP 121
3	Piston	AISI 316L
4	O-Ring 2037	FPM/FKM or EPDM or SILICONE FDA or SILICONE USP 121
5	Ring	AISI 316L
6	Grub Screw M4	AISI 304
7	Handle	PTFE + INOX

N°	Description	Valve size	Code
2+4	O-Ring Kit 3021 / 2037 FPM/FKM - n° 10 + 10 pcs	all sizes	ORSV1010V
2+4	O-Ring Kit 3021 / 2037 EPDM - n° 10 + 10 pcs	all sizes	ORSV1010EP
2+4	O-Ring Kit 3021 / 2037 SILICONE FDA - n° 10 + 10 pcs	all sizes	ORSV1010SIF
2+4	O-Ring Kit 3021 / 2037 SILICONE USP 121° - n° 10 + 10 pcs	all sizes	ORSV1010SI121
5	Ring - n° 1 pcs	all sizes	AAAA0090
6	Grub Screw M4 Kit - n° 10 pcs	all sizes	ORSVM4X10
7	Handle PTFE + INOX - n° 1 pcs	all sizes	ORSVHA1



ASTM A270 Tri-Clamp - Flange design according to ASME-BPE
DIN 32676 Tri-Clamp
ISO 1127 Tri-Clamp

Ø A	L1	L2	Valve Material	O-Rings Material	Code
25,00	40,00	51,50	1.4404	FPM/FKM	044H6TC25V
				EPDM	044H6TC25EP
				SILICONE FDA	044H6TC25SIF
				SILICONE USP 121	044H6TC25SI121
34,00	40,00	51,50	1.4404	FPM/FKM	044H6TC34V
				EPDM	044H6TC34EP
				SILICONE FDA	044H6TC34SIF
				SILICONE USP 121	044H6TC34SI121
50,50	46,50	58,00	1.4404	FPM/FKM	044H6TC50V
				EPDM	044H6TC50EP
				SILICONE FDA	044H6TC50SIF
				SILICONE USP 121	044H6TC50SI121

Int. finishing: **Ra ≤ 0,4 µm**
Ext. finishing: **Ra ≤ 0,8 µm Mirror Polished**

Max Working Conditions:
12 bar (170 psi) and 150°C (300°F)

Installation:
Horizontal installation recommended

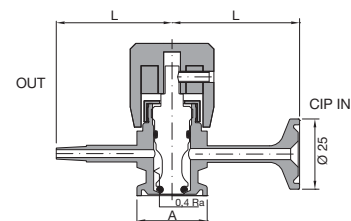

Spare parts

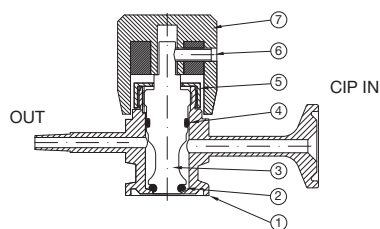

N°	Name	Material
1	Body	AISI 316L
2	O-Ring 3021	FPM/FKM or EPDM or SILICONE FDA or SILICONE USP 121
3	Piston	AISI 316L
4	O-Ring 2037	FPM/FKM or EPDM or SILICONE FDA or SILICONE USP 121
5	Ring	AISI 316L
6	Grub Screw M4	AISI 304
7	Handle	PTFE + INOX

N°	Description	Valve size	Code
2+4	O-Ring Kit 3021 / 2037 FPM/FKM - n° 10 + 10 pcs	all sizes	ORSV1010V
2+4	O-Ring Kit 3021 / 2037 EPDM - n° 10 + 10 pcs	all sizes	ORSV1010EP
2+4	O-Ring Kit 3021 / 2037 SILICONE FDA - n° 10 + 10 pcs	all sizes	ORSV1010SIF
2+4	O-Ring Kit 3021 / 2037 SILICONE USP 121° - n° 10 + 10 pcs	all sizes	ORSV1010SI121
5	Ring - n° 1 pcs	all sizes	AAAA0090
6	Grub Screw M4 Kit - n° 10 pcs	all sizes	ORSVM4X10
7	Handle PTFE + INOX - n° 1 pcs	all sizes	ORSVHA1



ASTM A270 Tri-Clamp - Flange design according to ASME-BPE
DIN 32676 Tri-Clamp
ISO 1127 Tri-Clamp

Ø A	L	Valve Material	O-Rings Material	Code
25,00	80,00	1.4404	FPM/FKM	045A6TC25V
			EPDM	045A6TC25EP
			SILICONE FDA	045A6TC25SIF
			SILICONE USP 121	045A6TC25SI121
34,00	80,00	1.4404	FPM/FKM	045A6TC34V
			EPDM	045A6TC34EP
			SILICONE FDA	045A6TC34SIF
			SILICONE USP 121	045A6TC34SI121
50,50	80,00	1.4404	FPM/FKM	045A6TC50V
			EPDM	045A6TC50EP
			SILICONE FDA	045A6TC50SIF
			SILICONE USP 121	045A6TC50SI121

Int. finishing: **Ra ≤ 0,4 µm**
Ext. finishing: **Ra ≤ 0,8 µm Mirror Polished**

Max Working Conditions:
12 bar (170 psi) and 150°C (300°F)

Installation:
Vertical installation recommended

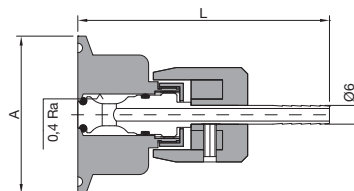

Spare parts

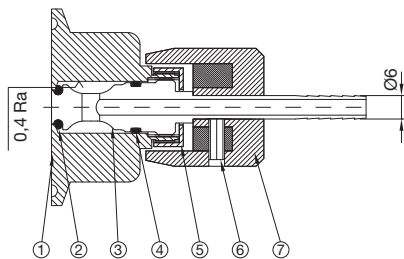

N°	Name	Material
1	Body	AISI 316L
2	O-Ring 3021	FPM/FKM or EPDM or SILICONE FDA or SILICONE USP 121
3	Piston	AISI 316L
4	O-Ring 2037	FPM/FKM or EPDM or SILICONE FDA or SILICONE USP 121
5	Ring	AISI 316L
6	Grub Screw M4	AISI 304
7	Handle	PTFE + INOX

N°	Description	Valve size	Code
2+4	O-Ring Kit 3021 / 2037 FPM/FKM - n° 10 + 10 pcs	all sizes	ORSV1010V
2+4	O-Ring Kit 3021 / 2037 EPDM - n° 10 + 10 pcs	all sizes	ORSV1010EP
2+4	O-Ring Kit 3021 / 2037 SILICONE FDA - n° 10 + 10 pcs	all sizes	ORSV1010SIF
2+4	O-Ring Kit 3021 / 2037 SILICONE USP 121° - n° 10 + 10 pcs	all sizes	ORSV1010SI121
5	Ring - n° 1 pcs	all sizes	AAAA0090
6	Grub Screw M4 Kit - n° 10 pcs	all sizes	ORSVM4X10
7	Handle PTFE + INOX - n° 1 pcs	all sizes	ORSVHA2



ASTM A270 Tri-Clamp - Flange design according to ASME-BPE
DIN 32676 Tri-Clamp
ISO 1127 Tri-Clamp

Ø A	L	Valve Material	O-Rings Material	Code
25,00	68,00	1.4404	FPM/FKM	045G6TC25V
			EPDM	045G6TC25EP
			SILICONE FDA	045G6TC25SIF
			SILICONE USP 121	045G6TC25SI121
34,00	68,00	1.4404	FPM/FKM	045G6TC34V
			EPDM	045G6TC34EP
			SILICONE FDA	045G6TC34SIF
			SILICONE USP 121	045G6TC34SI121
50,50	68,00	1.4404	FPM/FKM	045G6TC50V
			EPDM	045G6TC50EP
			SILICONE FDA	045G6TC50SIF
			SILICONE USP 121	045G6TC50SI121

Int. finishing: **Ra ≤ 0,4 µm**
Ext. finishing: **Ra ≤ 0,8 µm Mirror Polished**

Max Working Conditions:
12 bar (170 psi) and 150°C (300°F)

Installation:
Vertical installation recommended

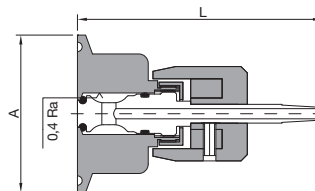

Spare parts

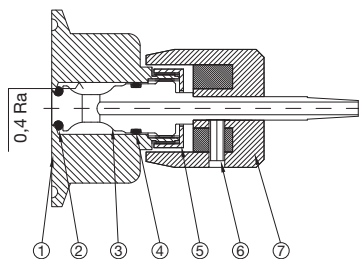

N°	Name	Material
1	Body	AISI 316L
2	O-Ring 3021	FPM/FKM or EPDM or SILICONE FDA or SILICONE USP 121
3	Piston	AISI 316L
4	O-Ring 2037	FPM/FKM or EPDM or SILICONE FDA or SILICONE USP 121
5	Ring	AISI 316L
6	Grub Screw M4	AISI 304
7	Handle	PTFE + INOX

N°	Description	Valve size	Code
2+4	O-Ring Kit 3021 / 2037 FPM/FKM - n° 10 + 10 pcs	all sizes	ORSV1010V
2+4	O-Ring Kit 3021 / 2037 EPDM - n° 10 + 10 pcs	all sizes	ORSV1010EP
2+4	O-Ring Kit 3021 / 2037 SILICONE FDA - n° 10 + 10 pcs	all sizes	ORSV1010SIF
2+4	O-Ring Kit 3021 / 2037 SILICONE USP 121° - n° 10 + 10 pcs	all sizes	ORSV1010SI121
5	Ring - n° 1 pcs	all sizes	AAAA0090
6	Grub Screw M4 Kit - n° 10 pcs	all sizes	ORSVM4X10
7	Handle PTFE + INOX - n° 1 pcs	all sizes	ORSVHA2

090

ART.

SIDE SAMPLING VALVES



30° O-RING SAMPLING VALVES

Characteristics: Side pipe sanitary sampling valves are designed for sampling of liquids on pharmaceutical, chemical, F&B and cosmetics products. O-Ring closing system.

Documentation: Laser marking for traceability and validation processes. Material 3.1 certificates, FDA or USP, internal surface finishing check as standard.

1 HOSE BARB OUTLET



ART. 090/A
P. 043

1 TRI-CLAMP OUTLET



ART. 090/B
P. 042

1 HOSE BARB OUTLET
+ 1 CIP HOSE BARB INLET



ART. 090/C
P. 045

1 HOSE BARB OUTLET
+ 1 CIP TRI-CLAMP INLET



ART. 090/D
P. 046

1 TRI-CLAMP OUTLET
+ 1 CIP TRI-CLAMP INLET



ART. 090/E
P. 047

1 LUER OUTLET



ART. 090/G
P. 048

1 LUER OUTLET
+ 1 CIP TRI-CLAMP INLET



ART. 090/H
P. 049



ASTM A270 Tri-Clamp - Flange design according to ASME-BPE
DIN 32676 Tri-Clamp
ISO 1127 Tri-Clamp

Ø A	L	Valve Material	O-Rings Material	Code
25,00	35,00	1.4404	FPM/FKM	090A6TC25V
			EPDM	090A6TC25EP
			SILICONE FDA	090A6TC25SIF
			SILICONE USP 121	090A6TC25SI121
34,00	35,00	1.4404	FPM/FKM	090A6TC34V
			EPDM	090A6TC34EP
			SILICONE FDA	090A6TC34SIF
			SILICONE USP 121	090A6TC34SI121
50,50	41,00	1.4404	FPM/FKM	090A6TC50V
			EPDM	090A6TC50EP
			SILICONE FDA	090A6TC50SIF
			SILICONE USP 121	090A6TC50SI121

Int. finishing: **Ra ≤ 0,4 µm**
Ext. finishing: **Ra ≤ 0,8 µm Mirror Polished**

Max Working Conditions:
12 bar (170 psi) and 150°C (300°F)

Installation:
Horizontal installation recommended

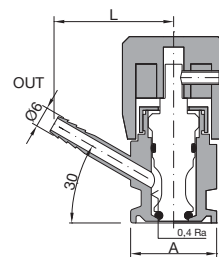

Spare parts

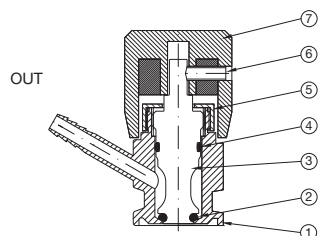

N°	Name	Material
1	Body	AISI 316L
2	O-Ring 3021	FPM/FKM or EPDM or SILICONE FDA or SILICONE USP 121
3	Piston	AISI 316L
4	O-Ring 2037	FPM/FKM or EPDM or SILICONE FDA or SILICONE USP 121
5	Ring	AISI 316L
6	Grub Screw M4	AISI 304
7	Handle	PTFE + INOX

N°	Description	Valve size	Code
2+4	O-Ring Kit 3021 / 2037 FPM/FKM - n° 10 + 10 pcs	all sizes	ORSV1010V
2+4	O-Ring Kit 3021 / 2037 EPDM - n° 10 + 10 pcs	all sizes	ORSV1010EP
2+4	O-Ring Kit 3021 / 2037 SILICONE FDA - n° 10 + 10 pcs	all sizes	ORSV1010SIF
2+4	O-Ring Kit 3021 / 2037 SILICONE USP 121° - n° 10 + 10 pcs	all sizes	ORSV1010SI121
5	Ring - n° 1 pcs	all sizes	AAAA0090
6	Grub Screw M4 Kit - n° 10 pcs	all sizes	ORSVM4X10
7	Handle PTFE + INOX - n° 1 pcs	all sizes	ORSVHA1



ASTM A270 Tri-Clamp - Flange design according to ASME-BPE
DIN 32676 Tri-Clamp
ISO 1127 Tri-Clamp

Ø A	L	Valve Material	O-Rings Material	Code
25,00	51,50	1.4404	FPM/FKM	090B6TC25V
			EPDM	090B6TC25EP
			SILICONE FDA	090B6TC25SIF
			SILICONE USP 121	090B6TC25SI121
34,00	51,50	1.4404	FPM/FKM	090B6TC34V
			EPDM	090B6TC34EP
			SILICONE FDA	090B6TC34SIF
			SILICONE USP 121	090B6TC34SI121
50,50	58,00	1.4404	FPM/FKM	090B6TC50V
			EPDM	090B6TC50EP
			SILICONE FDA	090B6TC50SIF
			SILICONE USP 121	090B6TC50SI121

Int. finishing: **Ra ≤ 0,4 µm**
Ext. finishing: **Ra ≤ 0,8 µm Mirror Polished**

Max Working Conditions:
12 bar (170 psi) and 150°C (300°F)

Installation:
Horizontal installation recommended

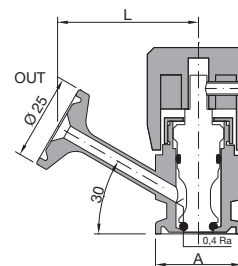

Spare parts

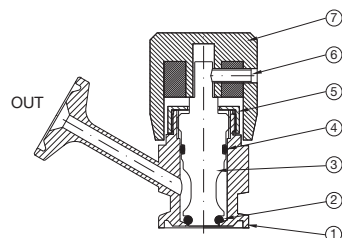

N°	Name	Material
1	Body	AISI 316L
2	O-Ring 3021	FPM/FKM or EPDM or SILICONE FDA or SILICONE USP 121
3	Piston	AISI 316L
4	O-Ring 2037	FPM/FKM or EPDM or SILICONE FDA or SILICONE USP 121
5	Ring	AISI 316L
6	Grub Screw M4	AISI 304
7	Handle	PTFE + INOX

N°	Description	Valve size	Code
2+4	O-Ring Kit 3021 / 2037 FPM/FKM - n° 10 + 10 pcs	all sizes	ORSV1010V
2+4	O-Ring Kit 3021 / 2037 EPDM - n° 10 + 10 pcs	all sizes	ORSV1010EP
2+4	O-Ring Kit 3021 / 2037 SILICONE FDA - n° 10 + 10 pcs	all sizes	ORSV1010SIF
2+4	O-Ring Kit 3021 / 2037 SILICONE USP 121° - n° 10 + 10 pcs	all sizes	ORSV1010SI121
5	Ring - n° 1 pcs	all sizes	AAAA0090
6	Grub Screw M4 Kit - n° 10 pcs	all sizes	ORSVM4X10
7	Handle PTFE + INOX - n° 1 pcs	all sizes	ORSVHA1



ASTM A270 Tri-Clamp - Flange design according to ASME-BPE
DIN 32676 Tri-Clamp
ISO 1127 Tri-Clamp

Ø A	L	Valve Material	O-Rings Material	Code
25,00	61,50	1.4404	FPM/FKM	090C6TC25V
			EPDM	090C6TC25EP
			SILICONE FDA	090C6TC25SIF
			SILICONE USP 121	090C6TC25SI121
34,00	61,50	1.4404	FPM/FKM	090C6TC34V
			EPDM	090C6TC34EP
			SILICONE FDA	090C6TC34SIF
			SILICONE USP 121	090C6TC34SI121
50,50	68,00	1.4404	FPM/FKM	090C6TC50V
			EPDM	090C6TC50EP
			SILICONE FDA	090C6TC50SIF
			SILICONE USP 121	090C6TC50SI121

Int. finishing: **Ra ≤ 0,4 µm**
Ext. finishing: **Ra ≤ 0,8 µm Mirror Polished**

Max Working Conditions:
12 bar (170 psi) and 150°C (300°F)

Installation:
Horizontal installation recommended

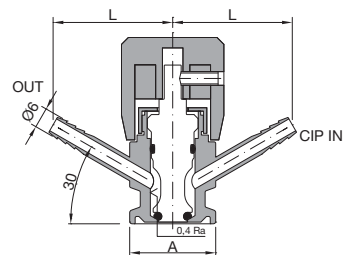

Spare parts

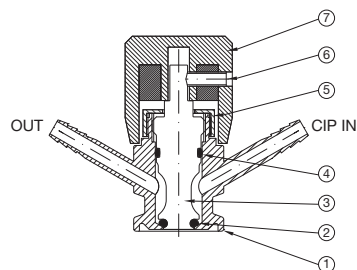

N°	Name	Material
1	Body	AISI 316L
2	O-Ring 3021	FPM/FKM or EPDM or SILICONE FDA or SILICONE USP 121
3	Piston	AISI 316L
4	O-Ring 2037	FPM/FKM or EPDM or SILICONE FDA or SILICONE USP 121
5	Ring	AISI 316L
6	Grub Screw M4	AISI 304
7	Handle	PTFE + INOX

N°	Description	Valve size	Code
2+4	O-Ring Kit 3021 / 2037 FPM/FKM - n° 10 + 10 pcs	all sizes	ORSV1010V
2+4	O-Ring Kit 3021 / 2037 EPDM - n° 10 + 10 pcs	all sizes	ORSV1010EP
2+4	O-Ring Kit 3021 / 2037 SILICONE FDA - n° 10 + 10 pcs	all sizes	ORSV1010SIF
2+4	O-Ring Kit 3021 / 2037 SILICONE USP 121° - n° 10 + 10 pcs	all sizes	ORSV1010SI121
5	Ring - n° 1 pcs	all sizes	AAAA0090
6	Grub Screw M4 Kit - n° 10 pcs	all sizes	ORSVM4X10
7	Handle PTFE + INOX - n° 1 pcs	all sizes	ORSVHA1



ASTM A270 Tri-Clamp - Flange design according to ASME-BPE
DIN 32676 Tri-Clamp
ISO 1127 Tri-Clamp

Ø A	L1	L2	Valve Material	O-Rings Material	Code
25,00	61,50	51,50	1.4404	FPM/FKM	090D6TC25V
				EPDM	090D6TC25EP
				SILICONE FDA	090D6TC25SIF
				SILICONE USP 121	090D6TC25SI121
34,00	61,50	51,50	1.4404	FPM/FKM	090D6TC34V
				EPDM	090D6TC34EP
				SILICONE FDA	090D6TC34SIF
				SILICONE USP 121	090D6TC34SI121
50,50	68,00	58,00	1.4404	FPM/FKM	090D6TC50V
				EPDM	090D6TC50EP
				SILICONE FDA	090D6TC50SIF
				SILICONE USP 121	090D6TC50SI121

Int. finishing: **Ra ≤ 0,4 µm**
Ext. finishing: **Ra ≤ 0,8 µm Mirror Polished**

Max Working Conditions:
12 bar (170 psi) and 150°C (300°F)

Installation:
Horizontal installation recommended

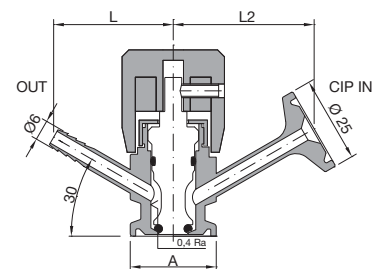

Spare parts

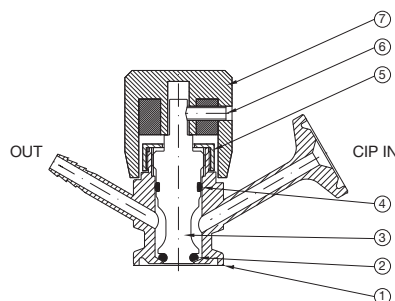

N°	Name	Material
1	Body	AISI 316L
2	O-Ring 3021	FPM/FKM or EPDM or SILICONE FDA or SILICONE USP 121
3	Piston	AISI 316L
4	O-Ring 2037	FPM/FKM or EPDM or SILICONE FDA or SILICONE USP 121
5	Ring	AISI 316L
6	Grub Screw M4	AISI 304
7	Handle	PTFE + INOX

N°	Description	Valve size	Code
2+4	O-Ring Kit 3021 / 2037 FPM/FKM - n° 10 + 10 pcs	all sizes	ORSV1010V
2+4	O-Ring Kit 3021 / 2037 EPDM - n° 10 + 10 pcs	all sizes	ORSV1010EP
2+4	O-Ring Kit 3021 / 2037 SILICONE FDA - n° 10 + 10 pcs	all sizes	ORSV1010SIF
2+4	O-Ring Kit 3021 / 2037 SILICONE USP 121° - n° 10 + 10 pcs	all sizes	ORSV1010SI121
5	Ring - n° 1 pcs	all sizes	AAAA0090
6	Grub Screw M4 Kit - n° 10 pcs	all sizes	ORSVM4X10
7	Handle PTFE + INOX - n° 1 pcs	all sizes	ORSVHA1



ASTM A270 Tri-Clamp - Flange design according to ASME-BPE
DIN 32676 Tri-Clamp
ISO 1127 Tri-Clamp

Ø A	L	Valve Material	O-Rings Material	Code
25,00	51,50	1.4404	FPM/FKM	090E6TC25V
			EPDM	090E6TC25EP
			SILICONE FDA	090E6TC25SIF
			SILICONE USP 121	090E6TC25SI121
34,00	51,50	1.4404	FPM/FKM	090E6TC34V
			EPDM	090E6TC34EP
			SILICONE FDA	090E6TC34SIF
			SILICONE USP 121	090E6TC34SI121
50,50	58,00	1.4404	FPM/FKM	090E6TC50V
			EPDM	090E6TC50EP
			SILICONE FDA	090E6TC50SIF
			SILICONE USP 121	090E6TC50SI121

Int. finishing: **Ra ≤ 0,4 µm**
Ext. finishing: **Ra ≤ 0,8 µm Mirror Polished**

Max Working Conditions:
12 bar (170 psi) and 150°C (300°F)

Installation:
Horizontal installation recommended

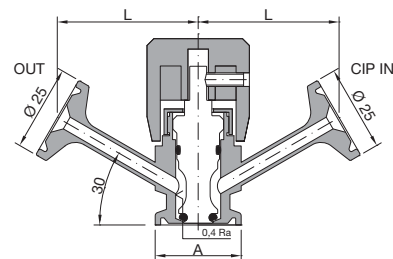

Spare parts

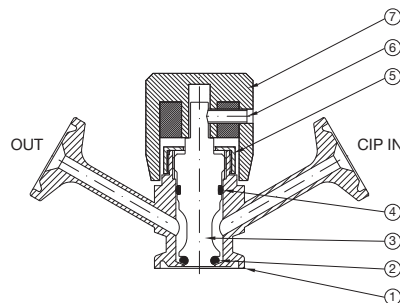

N°	Name	Material
1	Body	AISI 316L
2	O-Ring 3021	FPM/FKM or EPDM or SILICONE FDA or SILICONE USP 121
3	Piston	AISI 316L
4	O-Ring 2037	FPM/FKM or EPDM or SILICONE FDA or SILICONE USP 121
5	Ring	AISI 316L
6	Grub Screw M4	AISI 304
7	Handle	PTFE + INOX

N°	Description	Valve size	Code
2+4	O-Ring Kit 3021 / 2037 FPM/FKM - n° 10 + 10 pcs	all sizes	ORSV1010V
2+4	O-Ring Kit 3021 / 2037 EPDM - n° 10 + 10 pcs	all sizes	ORSV1010EP
2+4	O-Ring Kit 3021 / 2037 SILICONE FDA - n° 10 + 10 pcs	all sizes	ORSV1010SIF
2+4	O-Ring Kit 3021 / 2037 SILICONE USP 121° - n° 10 + 10 pcs	all sizes	ORSV1010SI121
5	Ring - n° 1 pcs	all sizes	AAAA0090
6	Grub Screw M4 Kit - n° 10 pcs	all sizes	ORSVM4X10
7	Handle PTFE + INOX - n° 1 pcs	all sizes	ORSVHA1



ASTM A270 Tri-Clamp - Flange design according to ASME-BPE
DIN 32676 Tri-Clamp
ISO 1127 Tri-Clamp

Ø A	L	Valve Material	O-Rings Material	Code
25,00	40,00	1.4404	FPM/FKM	090G6TC25V
			EPDM	090G6TC25EP
			SILICONE FDA	090G6TC25SIF
			SILICONE USP 121	090G6TC25SI121
34,00	40,00	1.4404	FPM/FKM	090G6TC34V
			EPDM	090G6TC34EP
			SILICONE FDA	090G6TC34SIF
			SILICONE USP 121	090G6TC34SI121
50,50	46,50	1.4404	FPM/FKM	090G6TC50V
			EPDM	090G6TC50EP
			SILICONE FDA	090G6TC50SIF
			SILICONE USP 121	090G6TC50SI121

Int. finishing: **Ra ≤ 0,4 µm**
Ext. finishing: **Ra ≤ 0,8 µm Mirror Polished**

Max Working Conditions:
12 bar (170 psi) and 150°C (300°F)

Installation:
Horizontal installation recommended

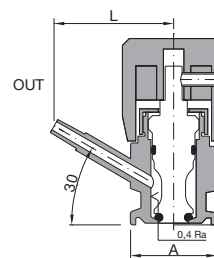

Spare parts

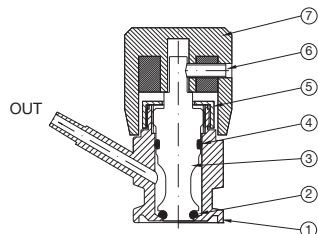

N°	Name	Material
1	Body	AISI 316L
2	O-Ring 3021	FPM/FKM or EPDM or SILICONE FDA or SILICONE USP 121
3	Piston	AISI 316L
4	O-Ring 2037	FPM/FKM or EPDM or SILICONE FDA or SILICONE USP 121
5	Ring	AISI 316L
6	Grub Screw M4	AISI 304
7	Handle	PTFE + INOX

N°	Description	Valve size	Code
2+4	O-Ring Kit 3021 / 2037 FPM/FKM - n° 10 + 10 pcs	all sizes	ORSV1010V
2+4	O-Ring Kit 3021 / 2037 EPDM - n° 10 + 10 pcs	all sizes	ORSV1010EP
2+4	O-Ring Kit 3021 / 2037 SILICONE FDA - n° 10 + 10 pcs	all sizes	ORSV1010SIF
2+4	O-Ring Kit 3021 / 2037 SILICONE USP 121° - n° 10 + 10 pcs	all sizes	ORSV1010SI121
5	Ring - n° 1 pcs	all sizes	AAAA0090
6	Grub Screw M4 Kit - n° 10 pcs	all sizes	ORSVM4X10
7	Handle PTFE + INOX - n° 1 pcs	all sizes	ORSVHA1



ASTM A270 Tri-Clamp - Flange design according to ASME-BPE
DIN 32676 Tri-Clamp
ISO 1127 Tri-Clamp

Ø A	L1	L2	Valve Material	O-Rings Material	Code
25,00	40,00	51,50	1.4404	FPM/FKM	090H6TC25V
				EPDM	090H6TC25EP
				SILICONE FDA	090H6TC25SIF
				SILICONE USP 121	090H6TC25SI121
34,00	40,00	51,50	1.4404	FPM/FKM	090H6TC34V
				EPDM	090H6TC34EP
				SILICONE FDA	090H6TC34SIF
				SILICONE USP 121	090H6TC34SI121
50,50	46,50	58,00	1.4404	FPM/FKM	090H6TC50V
				EPDM	090H6TC50EP
				SILICONE FDA	090H6TC50SIF
				SILICONE USP 121	090H6TC50SI121

Int. finishing: **Ra ≤ 0,4 µm**
Ext. finishing: **Ra ≤ 0,8 µm Mirror Polished**

Max Working Conditions:
12 bar (170 psi) and 150°C (300°F)

Installation:
Horizontal installation recommended

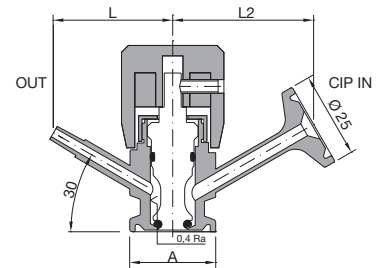

Spare parts

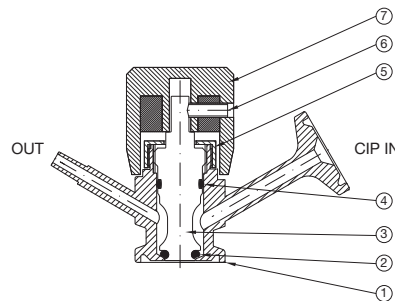

N°	Name	Material
1	Body	AISI 316L
2	O-Ring 3021	FPM/FKM or EPDM or SILICONE FDA or SILICONE USP 121
3	Piston	AISI 316L
4	O-Ring 2037	FPM/FKM or EPDM or SILICONE FDA or SILICONE USP 121
5	Ring	AISI 316L
6	Grub Screw M4	AISI 304
7	Handle	PTFE + INOX

N°	Description	Valve size	Code
2+4	O-Ring Kit 3021 / 2037 FPM/FKM - n° 10 + 10 pcs	all sizes	ORSV1010V
2+4	O-Ring Kit 3021 / 2037 EPDM - n° 10 + 10 pcs	all sizes	ORSV1010EP
2+4	O-Ring Kit 3021 / 2037 SILICONE FDA - n° 10 + 10 pcs	all sizes	ORSV1010SIF
2+4	O-Ring Kit 3021 / 2037 SILICONE USP 121° - n° 10 + 10 pcs	all sizes	ORSV1010SI121
5	Ring - n° 1 pcs	all sizes	AAAA0090
6	Grub Screw M4 Kit - n° 10 pcs	all sizes	ORSVM4X10
7	Handle PTFE + INOX - n° 1 pcs	all sizes	ORSVHA1



ASTM A270 Tri-Clamp - Flange design according to ASME-BPE

Size	Ø A	B	L	Valve Material	O-Rings Material	Code
DN 25	25,00	40,00	41,00	1.4404	FPM/FKM	091E6IN025V
					EPDM	091E6IN025EP
					SILICONE FDA	091E6IN025SIF
					SILICONE USP 121	091E6IN025SI121

Int. finishing: **Ra ≤ 0,4 µm**
Ext. finishing: **Ra ≤ 0,8 µm Mirror Polished**

Max Working Conditions:
12 bar (170 psi) and 150°C (300°F)

Installation:
Horizontal installation recommended

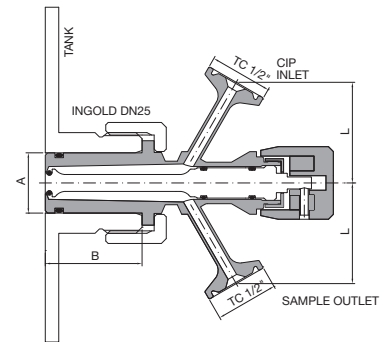

Spare parts

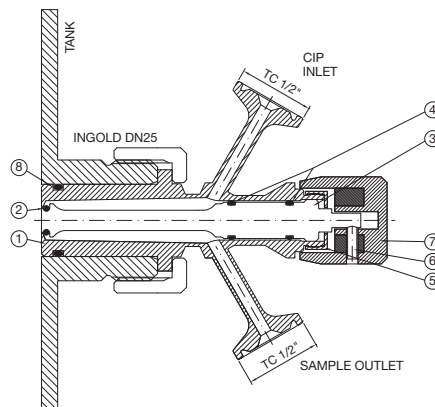

N°	Name	Material
1	Body	AISI 316L
2	O-Ring 3021	FPM/FKM or EPDM or SILICONE FDA or SILICONE USP 121
3	Piston	AISI 316L
4	O-Ring 2037	FPM/FKM or EPDM or SILICONE FDA or SILICONE USP 121
5	Ring	AISI 316L
6	Grub Screw M4	AISI 304
7	Handle	PTFE + INOX
8	O-Ring 3081	FPM/FKM or EPDM or SILICONE FDA or SILICONE USP 121

N°	Description	Valve size	Code
2+4	O-Ring Kit 3021 / 2037 / 3081 FPM/FKM - n° 10 + 20 + 10 pcs	all sizes	ORSV102010V
2+4	O-Ring Kit 3021 / 2037 / 3081 EPDM - n° 10 + 20 + 10 pcs	all sizes	ORSV102010EP
2+4	O-Ring Kit 3021 / 2037 / 3081 SILICONE FDA - n° 10 + 20 + 10 pcs	all sizes	ORSV102010SIF
2+4	O-Ring Kit 3021 / 2037 / 3081 SILICONE USP 121° - n° 10 + 20 + 10 pcs	all sizes	ORSV102010SI121
5	Ring - n° 1 pcs	all sizes	AAAA0090
6	Grub Screw M4 Kit - n° 10 pcs	all sizes	ORSVM4X10
7	Handle PTFE + INOX - n° 1 pcs	all sizes	ORSVHA1



ASTM A270 Tri-Clamp - Flange design according to ASME-BPE

Size	Ø A	B	L	Valve Material	O-Rings Material	Code
DN 25	25,00	40,00	41,00	1.4404	FPM/FKM	091F6IN025V
					EPDM	091F6IN025EP
					SILICONE FDA	091F6IN025SIF
					SILICONE USP 121	091F6IN025SI121

Int. finishing: **Ra ≤ 0,4 µm**
Ext. finishing: **Ra ≤ 0,8 µm Mirror Polished**

Max Working Conditions:
12 bar (170 psi) and 150°C (300°F)

Installation:
Horizontal installation recommended

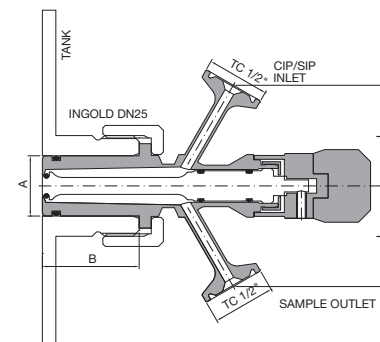

Spare parts

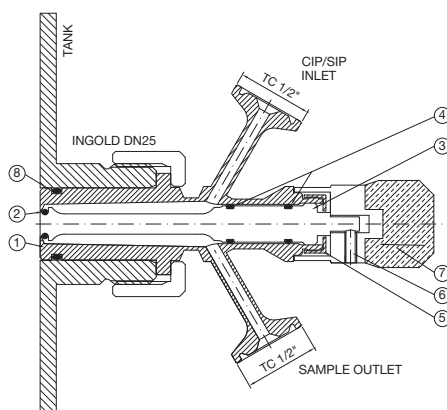

N°	Name	Material
1	Body	AISI 316L
2	O-Ring 3021	FPM/FKM or EPDM or SILICONE FDA or SILICONE USP 121
3	Piston	AISI 316L
4	O-Ring 2037	FPM/FKM or EPDM or SILICONE FDA or SILICONE USP 121
5	Ring	AISI 316L
6	Grub Screw M4	AISI 304
7	Removable Handle	PTFE + INOX
8	O-Ring 3081	FPM/FKM or EPDM or SILICONE FDA or SILICONE USP 121

N°	Description	Valve size	Code
2+4	O-Ring Kit 3021 / 2037 / 3081 FPM/FKM - n° 10 + 20 + 10 pcs	all sizes	ORSV102010V
2+4	O-Ring Kit 3021 / 2037 / 3081 EPDM - n° 10 + 20 + 10 pcs	all sizes	ORSV102010EP
2+4	O-Ring Kit 3021 / 2037 / 3081 SILICONE FDA - n° 10 + 20 + 10 pcs	all sizes	ORSV102010SIF
2+4	O-Ring Kit 3021 / 2037 / 3081 SILICONE USP 121 - n° 10 + 20 + 10 pcs	all sizes	ORSV102010SI121
5	Ring - n° 1 pcs	all sizes	AAAA0090
6	Grub Screw M4 Kit - n° 10 pcs	all sizes	ORSVM4X10
7	Removable Handle PTFE + INOX - n° 1 pcs	all sizes	091F600007PTF



ART. 023/A

ART. 023/C

ART. 023/A 1 Hose Barb Outlet

ASTM A270 Tri-Clamp - Flange design according to ASME-BPE

Size	Ø B	L	Valve Material	O-Ring Material	Code
1/2"	6,00	38,00	1.4404	FPM/FKM	023A60050V
				EPDM	023A60050EP
				SILICONE FDA	023A60050SIF
3/4"	6,00	38,00	1.4404	FPM/FKM	023A60075V
				EPDM	023A60075EP
				SILICONE FDA	023A60075SIF

Int. finishing: **Ra ≤ 1,2 µm**
Ext. finishing: **Ra ≤ 1,6 µm mirror polished**

Max Working Conditions:
6 bar (87 psi) and 150°C (300°F)

Installation:
Horizontal installation recommended

ART. 023/C 1 Hose Barb Outlet + 1 CIP Hose Barb Inlet

ASTM A270 Tri-Clamp - Flange design according to ASME-BPE

Size	Ø B	L	Valve Material	O-Ring Material	Code
1/2"	6,00	38,00	1.4404	FPM/FKM	023C60050V
				EPDM	023C60050EP
				SILICONE FDA	023C60050SIF
3/4"	6,00	38,00	1.4404	FPM/FKM	023C60075V
				EPDM	023C60075EP
				SILICONE FDA	023C60075SIF

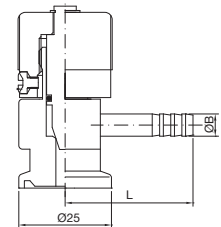

ART. 023/A

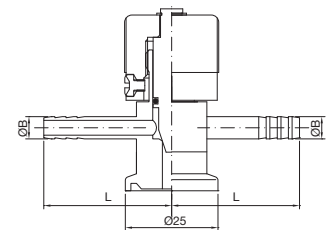

ART. 023/C

Spare parts

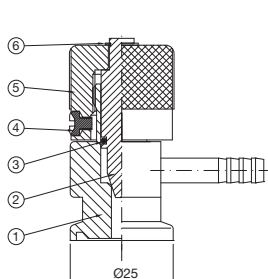

ART. 023/A

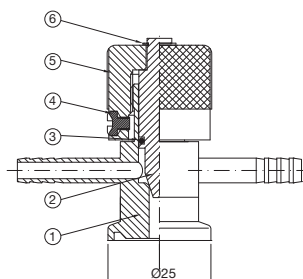

ART. 023/C

N°	Name	Material
1	Body	AISI 316L
2	Piston	AISI 316L
3	O-Ring 2025	FPM/FKM or EPDM or SILICONE FDA
4	M3 Screw	AISI 304
5	Handle	AISI 316L
6	Seeger	AISI 304

N°	Description	Valve size	Code
2	Piston - n° 1 pcs	all sizes	AAAA0381
3	O-Ring Kit 2025 FPM/FKM - n° 5 pcs	all sizes	ORNSV05V
3	O-Ring Kit 2025 EPDM - n° 5 pcs	all sizes	ORNSV05EP
3	O-Ring Kit 2025 SILICONE FDA - n° 5 pcs	all sizes	ORNSV05SIF
5	Handle - n° 1 pcs	all sizes	AAAA0380
6	Seeger - n° 10 pcs	all sizes	SEEGERSV



Male Gas Threaded

Size	Ø B	L	Valve Material	O-Ring Material	Code
1/4"	6,00	38,00	1.4404	FPM/FKM	022Z60025V
				EPDM	022Z60025EP
				SILICONE FDA	022Z60025SIF

Int. finishing: $Ra \leq 1,2 \mu m$

Ext. finishing: $Ra \leq 1,6 \mu m$ mirror polished

Max Working Conditions:

6 bar (87 psi) and 150°C (300°F)

Installation:

Horizontal installation recommended

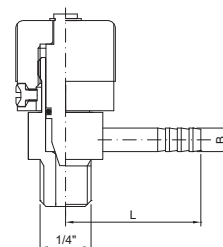

Spare parts

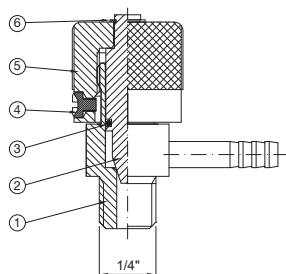

N°	Name	Material
1	Body	AISI 316L
2	Piston	AISI 316L
3	O-Ring 2025	FPM/FKM or EPDM or SILICONE FDA
4	M3 Screw	AISI 304
5	Handle	AISI 316L
6	Seeger	AISI 304

N°	Description	Valve size	Code
2	Piston - n° 1 pcs	all sizes	AAAA0381
3	O-Ring Kit 2025 FPM/FKM - n° 5 pcs	all sizes	ORNSV05V
3	O-Ring Kit 2025 EPDM - n° 5 pcs	all sizes	ORNSV05EP
3	O-Ring Kit 2025 SILICONE FDA - n° 5 pcs	all sizes	ORNSV05SIF
5	Handle - n° 1 pcs	all sizes	AAAA0380
6	Seeger - n° 10 pcs	all sizes	SEEGERSV



ASTM A270 Tri-Clamp - Flange design according to ASME-BPE

Size	A	Ø B	L	Valve Material	O-Ring Material	Code
1/2"	17,00	6,00	66,00	1.4404	FPM/FKM	041Z60050V
					EPDM	041Z60050EP
					SILICONE FDA	041Z60050SIF
3/4"	17,00	6,00	66,00	1.4404	FPM/FKM	041Z60075V
					EPDM	041Z60075EP
					SILICONE FDA	041Z60075SIF

Int. finishing: **Ra ≤ 1,2 µm**
Ext. finishing: **Ra ≤ 1,6 µm mirror polished**

Max Working Conditions:
6 bar (87 psi) and 150°C (300°F)

Installation:
Vertical installation recommended

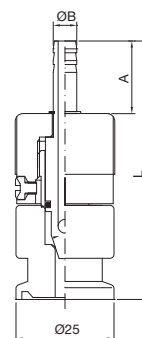

Spare parts

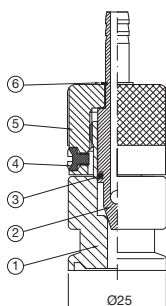

N°	Name	Material
1	Body	AISI 316L
2	Piston	AISI 316L
3	O-Ring 2025	FPM/FKM or EPDM or SILICONE FDA
4	M3 Screw	AISI 304
5	Handle	AISI 316L
6	Seeger	AISI 304

N°	Description	Valve size	Code
2	Piston - n° 1 pcs	all sizes	AAAA0382
3	O-Ring Kit 2025 FPM/FKM - n° 5 pcs	all sizes	ORNSV05V
3	O-Ring Kit 2025 EPDM - n° 5 pcs	all sizes	ORNSV05EP
3	O-Ring Kit 2025 SILICONE FDA - n° 5 pcs	all sizes	ORNSV05SIF
5	Handle - n° 1 pcs	all sizes	AAAA0380
6	Seeger - n° 10 pcs	all sizes	SEEGERSV



Male Gas Threaded

Size	A	Ø B	L	Valve Material	O-Ring Material	Code
1/4"	17,00	6,00	54,00	1.4404	FPM/FKM	033Z60025V
					EPDM	033Z60025EP
					SILICONE FDA	033Z60025SIF

Int. finishing: $Ra \leq 1,2 \mu m$
 Ext. finishing: $Ra \leq 1,6 \mu m$ mirror polished

Max Working Conditions:
6 bar (87 psi) and 150°C (300°F)

Installation:
Vertical installation recommended

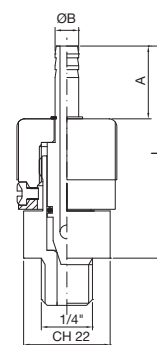

Spare parts

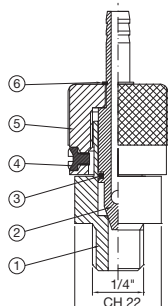

N°	Name	Material
1	Body	AISI 316L
2	Piston	AISI 316L
3	O-Ring 2025	FPM/FKM or EPDM or SILICONE FDA
4	M3 Screw	AISI 304
5	Handle	AISI 316L
6	Seeger	AISI 304

N°	Description	Valve size	Code
2	Piston - n° 1 pcs	all sizes	AAAA0382
3	O-Ring Kit 2025 FPM/FKM - n° 5 pcs	all sizes	ORNSV05V
3	O-Ring Kit 2025 EPDM - n° 5 pcs	all sizes	ORNSV05EP
3	O-Ring Kit 2025 SILICONE FDA - n° 5 pcs	all sizes	ORNSV05SIF
5	Handle - n° 1 pcs	all sizes	AAAA0380
6	Seeger - n° 10 pcs	all sizes	SEEGERSV



ART. 344/A

ART. 344/C

ART. 344/A 1 Hose Barb Outlet

Ø A	L	Valve Material	O-Ring Material	Code
3/8"	61,50	1.4404	FPM/FKM	344A6BSPP37V
			EPDM	344A6BSPP37EP
			SILICONE FDA	344A6BSPP37SIF
			SILICONE USP 121	344A6BSPP37SI121

Int. finishing: $Ra \leq 0,4 \mu m$
Ext. finishing: $Ra \leq 0,8 \mu m$ mirror polished

Max Working Conditions:
12 bar (170 psi) and 150°C (300°F)

Installation:
Horizontal installation recommended

ART. 344/C 1 Hose Barb Outlet + 1 CIP Hose Barb Inlet

Ø A	L	Valve Material	O-Ring Material	Code
3/8"	61,50	1.4404	FPM/FKM	344C6BSPP37V
			EPDM	344C6BSPP37EP
			SILICONE FDA	344C6BSPP37SIF
			SILICONE USP 121	344C6BSPP37SI121

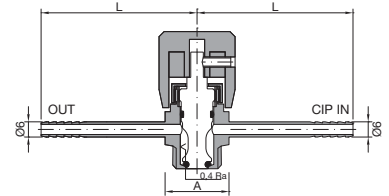
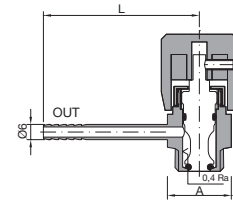

Spare parts

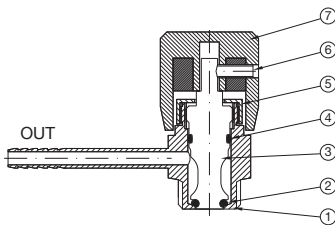

ART. 344/A

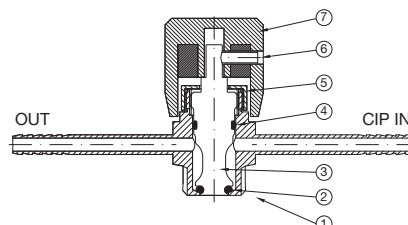

ART. 344/C

N°	Name	Material
1	Body	AISI 316L
2	O-Ring 3021	FPM/FKM or EPDM or SILICONE FDA or SILICONE USP 121
3	Piston	AISI 316L
4	O-Ring 2037	FPM/FKM or EPDM or SILICONE FDA or SILICONE USP 121
5	Ring	AISI 316L
6	Grub Screw M4	AISI 304
7	Handle	PTFE + INOX

N°	Description	Valve size	Code
2+4	O-Ring Kit 3021 / 2037 FPM/FKM - n° 10 + 10 pcs	all sizes	ORSV1010V
2+4	O-Ring Kit 3021 / 2037 EPDM - n° 10 + 10 pcs	all sizes	ORSV1010EP
2+4	O-Ring Kit 3021 / 2037 SILICONE FDA - n° 10 + 10 pcs	all sizes	ORSV1010SIF
2+4	O-Ring Kit 3021 / 2037 SILICONE USP 121° - n° 10 + 10 pcs	all sizes	ORSV1010SI121
5	Ring - n° 1 pcs	all sizes	AAAA0090
6	Grub Screw M4 Kit - n° 10 pcs	all sizes	ORSVM4X10
7	Handle PTFE + INOX - n° 1 pcs	all sizes	ORSVHA1



ART. 390/A

ART. 390/C

ART. 390/A 1 Hose Barb Outlet

Ø A	L	Valve Material	O-Ring Material	Code
3/8"	61,50	1.4404	FPM/FKM	390A6BSPP37V
			EPDM	390A6BSPP37EP
			SILICONE FDA	390A6BSPP37SIF
			SILICONE USP 121	390A6BSPP37SI121

Int. finishing: **Ra ≤ 0,4 µm**
Ext. finishing: **Ra ≤ 0,8 µm mirror polished**

Max Working Conditions:
12 bar (170 psi) and 150°C (300°F)

Installation:
Horizontal installation recommended

ART. 390/C 1 Hose Barb Outlet + 1 CIP Hose Barb Inlet

Ø A	L	Valve Material	O-Ring Material	Code
3/8"	61,50	1.4404	FPM/FKM	390C6BSPP37V
			EPDM	390C6BSPP37EP
			SILICONE FDA	390C6BSPP37SIF
			SILICONE USP 121	390C6BSPP37SI121

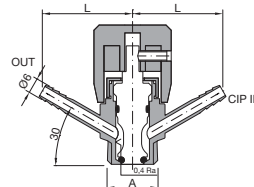
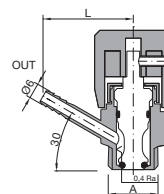

Spare parts

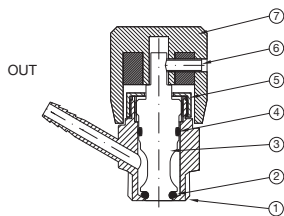

ART. 390/A

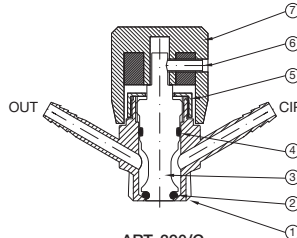

ART. 390/C

N°	Name	Material
1	Body	AISI 316L
2	O-Ring 3021	FPM/FKM or EPDM or SILICONE FDA or SILICONE USP 121
3	Piston	AISI 316L
4	O-Ring 2037	FPM/FKM or EPDM or SILICONE FDA or SILICONE USP 121
5	Ring	AISI 316L
6	Grub Screw M4	AISI 304
7	Handle	PTFE + INOX

N°	Description	Valve size	Code
2+4	O-Ring Kit 3021 / 2037 FPM/FKM - n° 10 + 10 pcs	all sizes	ORSV1010V
2+4	O-Ring Kit 3021 / 2037 EPDM - n° 10 + 10 pcs	all sizes	ORSV1010EP
2+4	O-Ring Kit 3021 / 2037 SILICONE FDA - n° 10 + 10 pcs	all sizes	ORSV1010SIF
2+4	O-Ring Kit 3021 / 2037 SILICONE USP 121 - n° 10 + 10 pcs	all sizes	ORSV1010SI121
5	Ring - n° 1 pcs	all sizes	AAAA0090
6	Grub Screw M4 Kit - n° 10 pcs	all sizes	ORSVM4X10
7	Handle PTFE + INOX - n° 1 pcs	all sizes	ORSVHA1